

The Living Pool



The Living Pool

01 Integration in the landscape

02 Customization

03 Furnishing

04 Wellness

05 Value

01

Integration in the Landscape

Each of us, at least once in our lifetime, has dreamed of living in a villa with a garden and a beautiful swimming pool to enjoy on hot summer days.

Too often, however, this becomes a sore point in our dream ... ongoing maintenance, lines which are too square and, above all, an aesthetic which is anything but pleasant during the colder seasons.

There is no sense in pretending otherwise: pools covered by tarpaulins or - worse yet - full of leaves and rainwater are anything but a pretty sight. TermaPond is the solution to all this!

Its construction features and natural materials make TermaPond a real furnishing for the garden; an element of aesthetic design that fits perfectly in the context that hosts it.

This body of water will change with the changing seasons always offering an image integrated in the garden, a panorama to be enjoyed at any time.

Thanks to the possibility of constructing your TermaPond the way you prefer - by adding perimeter monoliths or sprays of water, solariums with natural paving, decorating it all with beds of flowering or scented shrubs - you can create a real jewel in your garden: a unique space to enjoy at any time.







Customization

With Terma Pond you can create a unique object. Choose the shape of the pool following our style, model the bed according to all specific bathing requirements, decorate every detail of your corner of paradise. A simple poolside area can become a wide contoured seat for ultimate relaxation; the beach - a favourite of bathers - can be connected to an inclined plane to make access to the deep zone safe, and the length of the pool can be the ideal area for swimming.



03

Furnishing

TermaPond will never be a foreign body in a garden, but a body of water that transforms along with the changing seasons, an ever harmonious presence.

In winter, when wrapped in leaves or snow, TermaPond continues to be a feast for the eyes.

Finally, the natural materials that comprise it and the technological compatibility of all materials significantly facilitate the granting of construction permits.



04

Well-being

A TermaPond pool can also become a private spa with the ability to include seats with jets, air therapy geysers, submerged loungers, and swimming areas. The natural stone finish, combined with the water enriched with beneficial minerals such as Himalayan salts, make the pool not only a place for fun, but a space for relaxation and meditation. Your space.



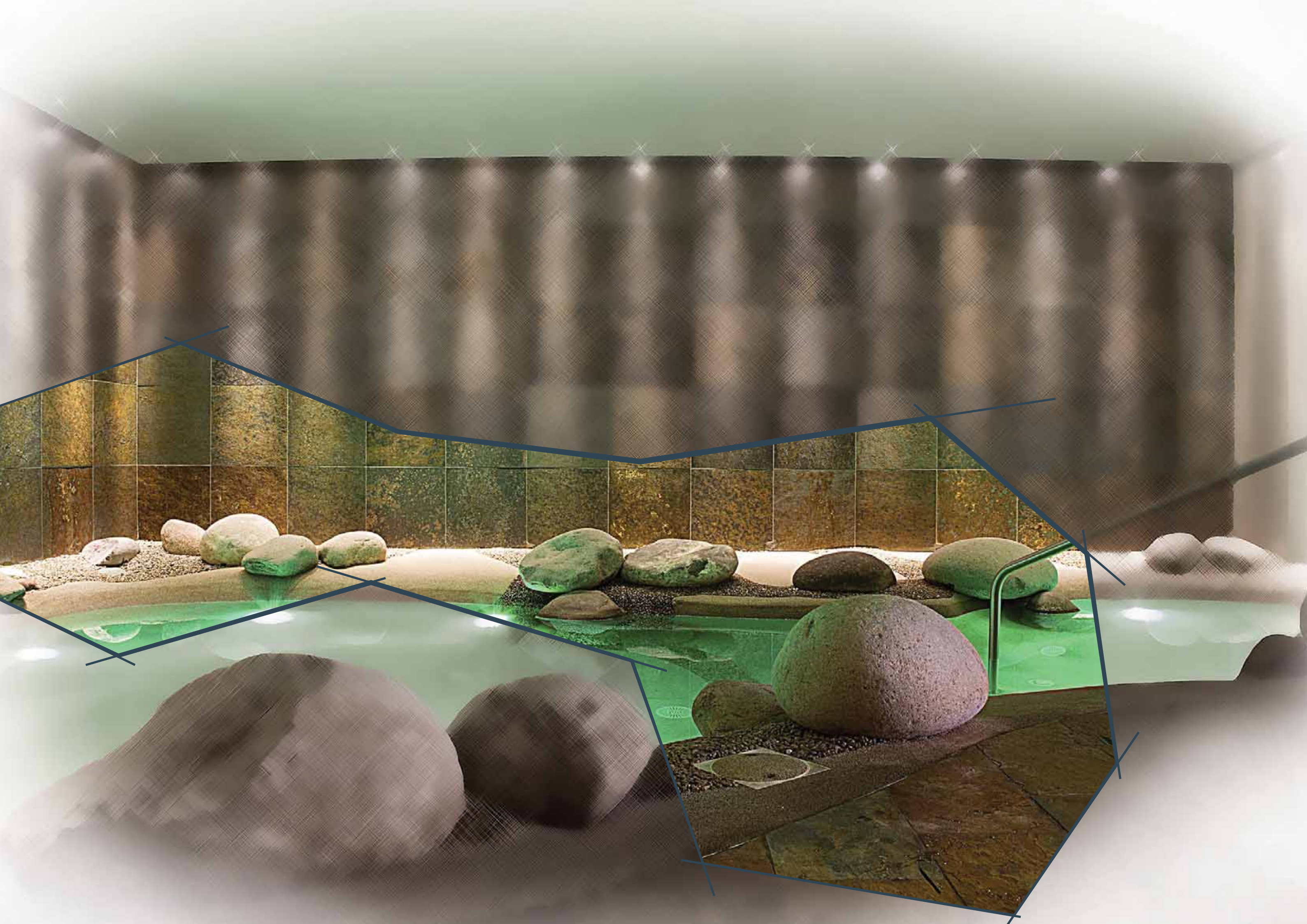

05

Value

With a Termapond pool it is possible to enjoy summer days in a space which meets your every need since it is designed by you. During the cold season the pool will turn into a furnishing that will accentuate the garden with its beauty.

Investing in Termapond also has economic value, a solid investment in the property owned.

It is a quick and minimally invasive investment thanks to Termapond construction technology that involves rapid installation and minimal invasiveness of all the preparation works thereby avoiding the need for major works to restore the garden after the construction of the pool.



Customization

Name _____
Description Location _____
Dimensions length _____ width _____

Preferences for the shape

- Area for Children
- Frontal Beach
- Extended Swimming Area
- Lateral Beach
- Air therapy Beach
- Bottom Geysers
- Onyx Monoliths
- Native monoliths
- Seats
- Thermalization of the water
- Himalayan Salts for Electrolysis

Model Selected _____
Notes _____

The maximum indicative depth of the water depends on the size of the pool: having an excessive depth of water over the pool bed makes it less visible, the average water temperature cooler, and a greater volume of water to be treated.

(Type1 max 110cm - Type2 max 120cm - Type3 max 130cm - Type4 max 140cm - Type5 max 150cm - Type6 max 160cm - the remaining types have a constant maximum depth of 160cm with a little discretion to be assessed with the Termapond dealer/installer)

Natural finishes

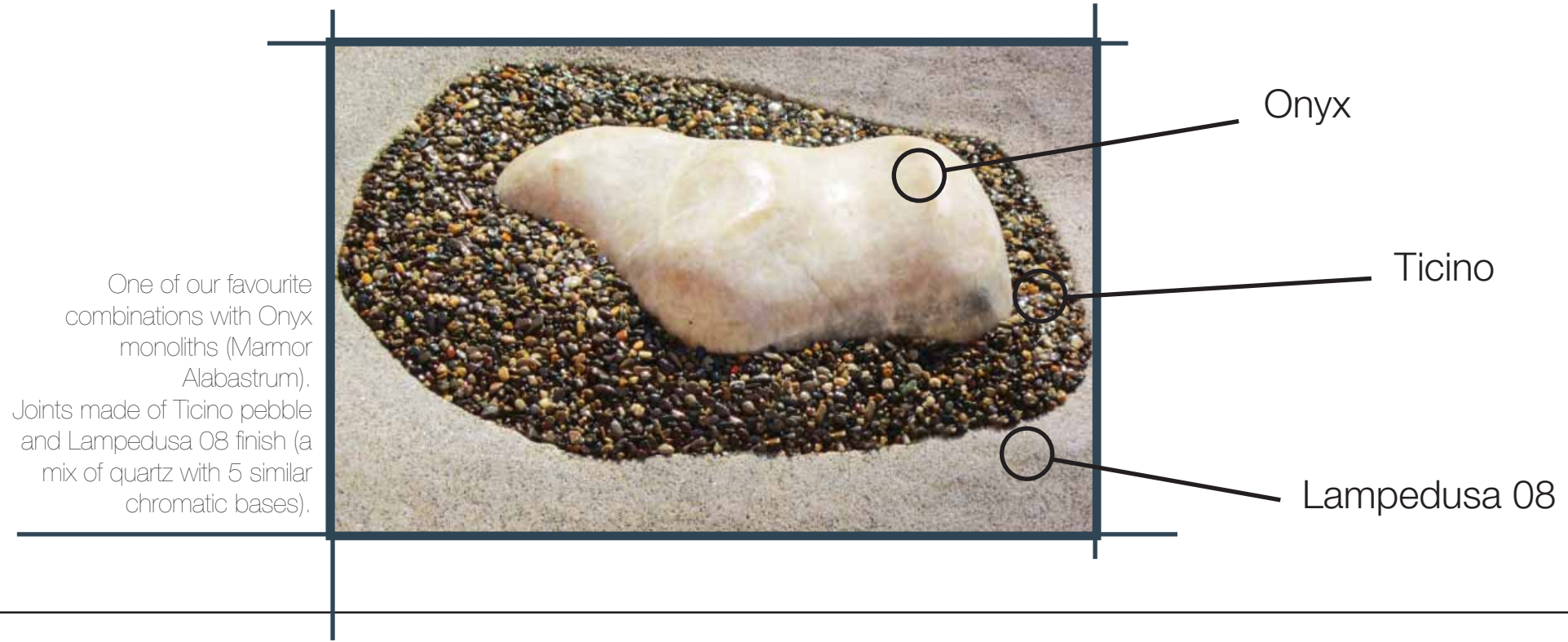
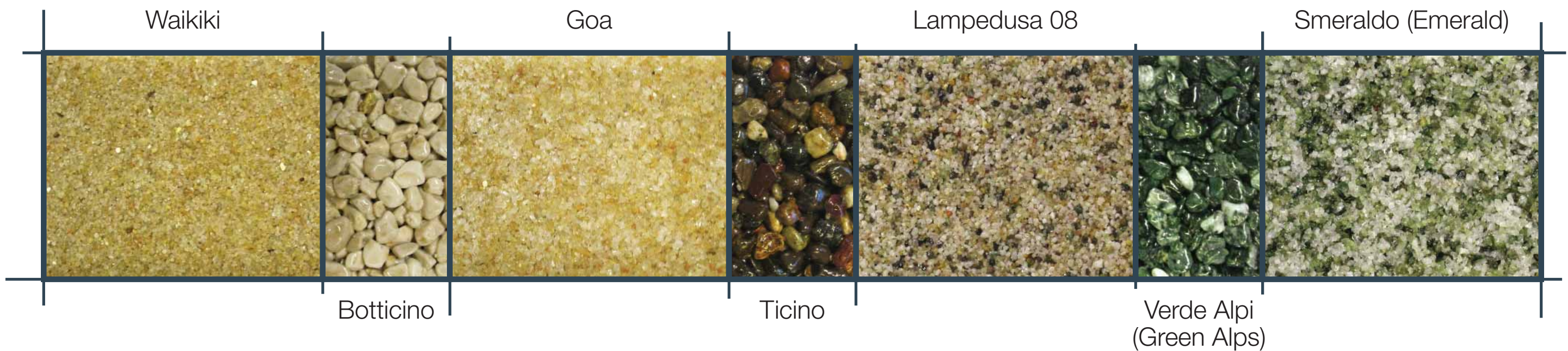



TP 01

The slightly rounded shape of this model adapts to both small and large sizes. In larger sizes you can create two separate beaches, in the others the small inlet can be used for seats or chaises longues with massaging water jets. Across from the beaches we recommend a small seat on the pool edge.

	A			B			C			D		
type	1	2	3	4	5	6	7	8	9	10	11	12
length	5,09	7,08	8,42	9,56	10,61	11,56	12,43	13,25	14,02	14,74	15,42	16,09
width	3,59	4,92	5,81	6,68	7,38	8,02	8,62	9,17	9,69	10,18	10,65	11,10
max water depth	1,1	1,2	1,3	1,4	1,5	1,6	1,6	1,6	1,6	1,6	1,6	1,6
	✓	✓	✓	✓	✓	✓	✓	✓	✓	✓	✓	✓

The dimensions are expressed in meters. Length and width are inclusive of the 30cm outer edge.

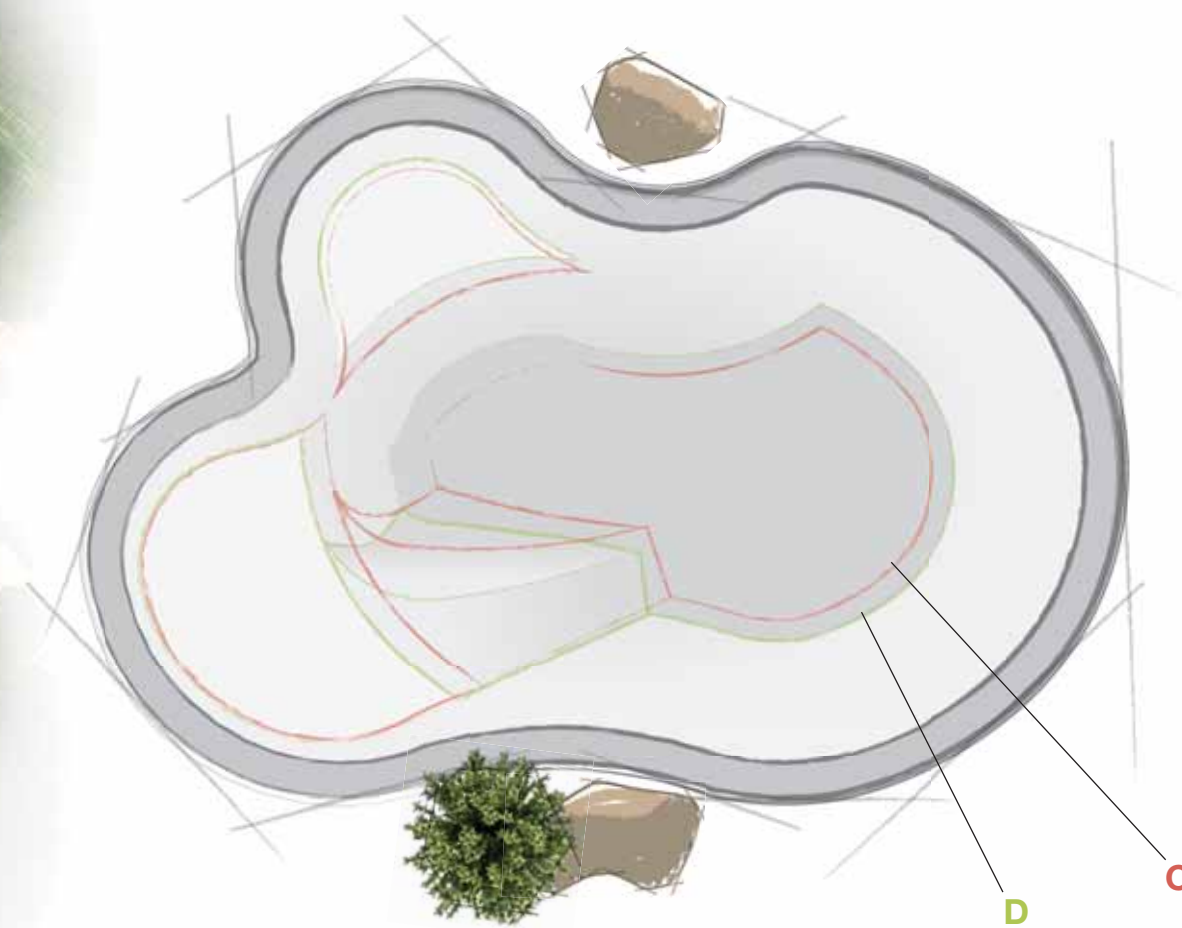
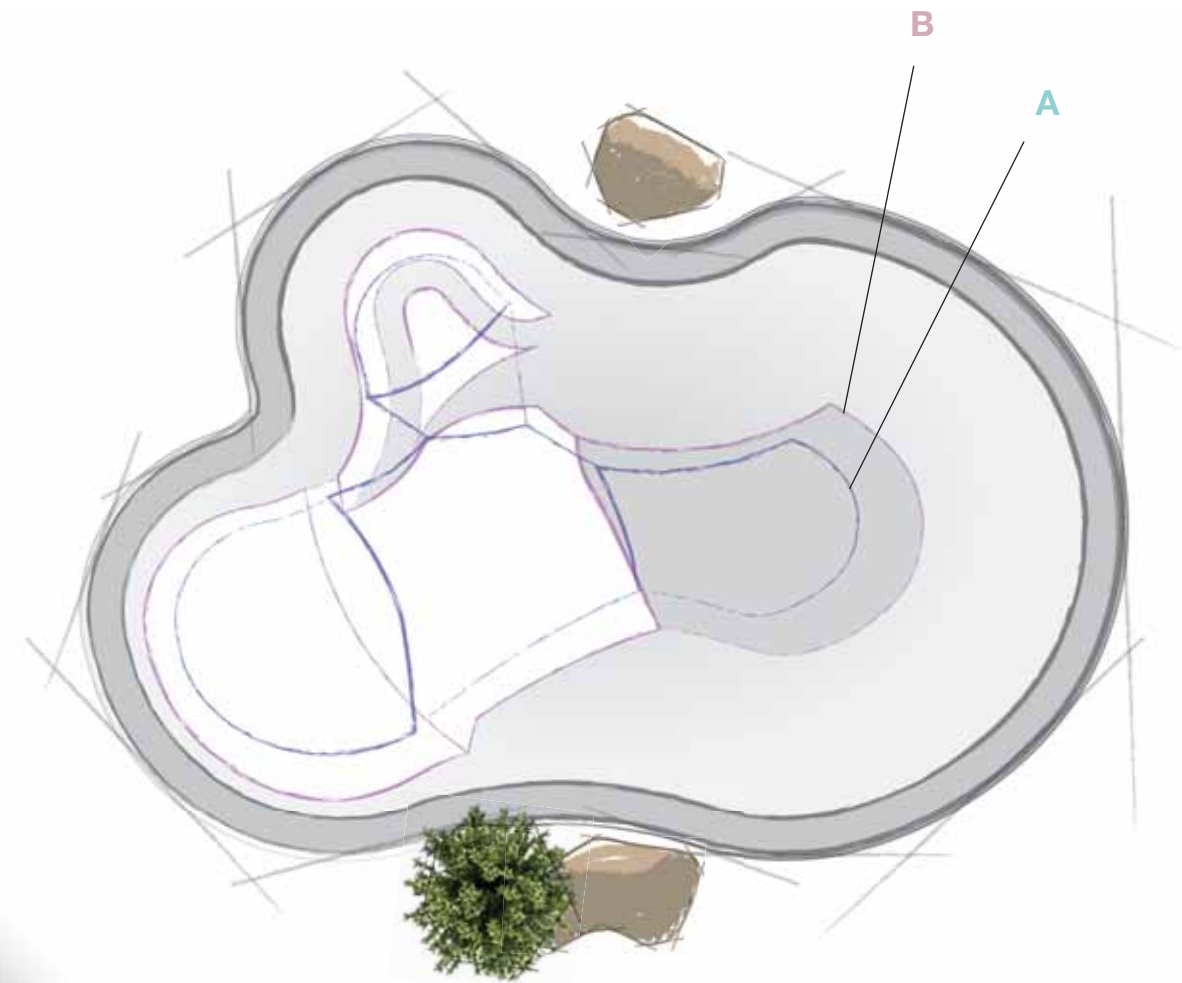



TP 02

This shape is very conducive to natural landscaping. Near the concave lines we recommend creating beds of shrubs or placing monoliths with joints made of pebble down to the pool bed. In the larger models the swimming line is well separated from the beach area. With this model the external concave areas around the beach can be designed with a sunbathing area paved with sand or wood.

	A			B			C			D		
type	1	2	3	4	5	6	7	8	9	10	11	12
length	4,44	6,02	7,20	8,17	9,07	9,87	10,61	11,33	12,05	12,67	13,26	13,82
width	4,44	6,02	7,20	8,40	9,32	10,15	10,91	11,64	12,34	12,97	13,58	14,15
max water depth	1,1	1,2	1,3	1,4	1,5	1,6	1,6	1,6	1,6	1,6	1,6	1,6
	✓	✓	✓	✓	✓	✓	✓	✓	✓	✓	✓	✓

The dimensions are expressed in meters. Length and width are inclusive of the 30cm outer edge.

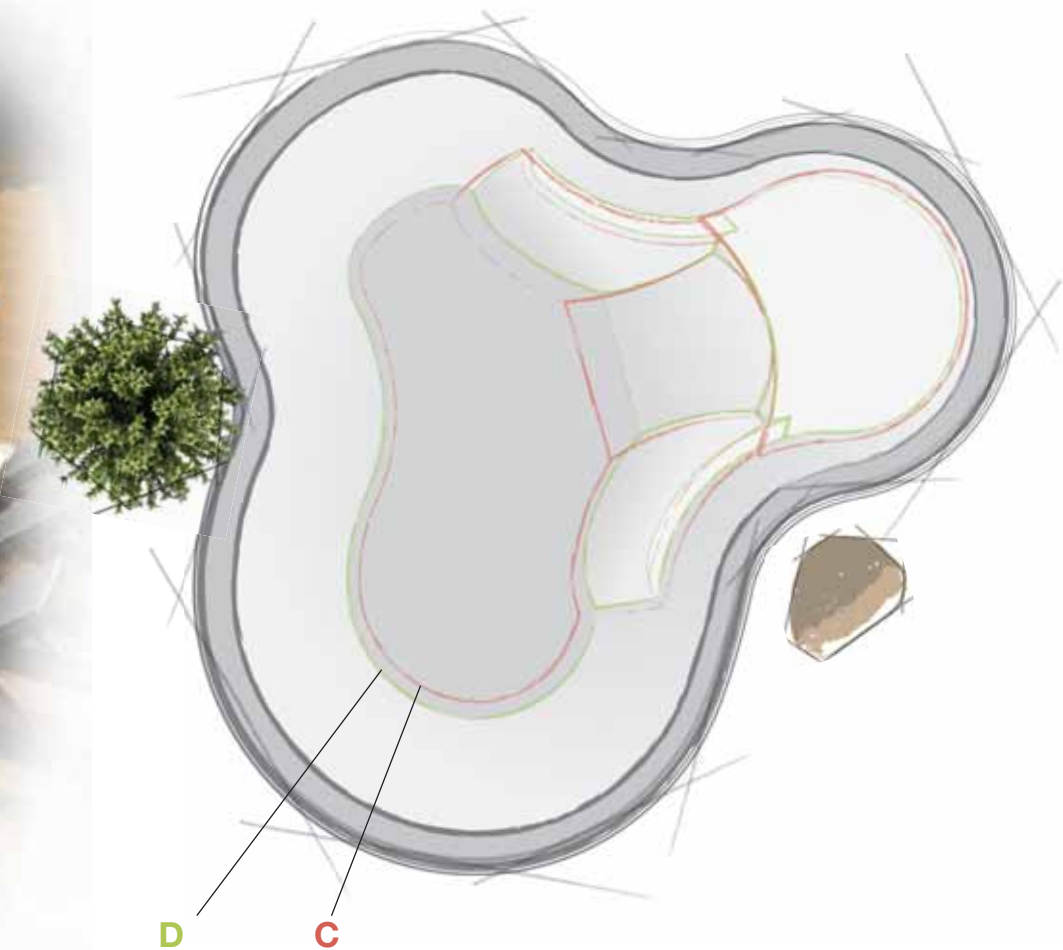
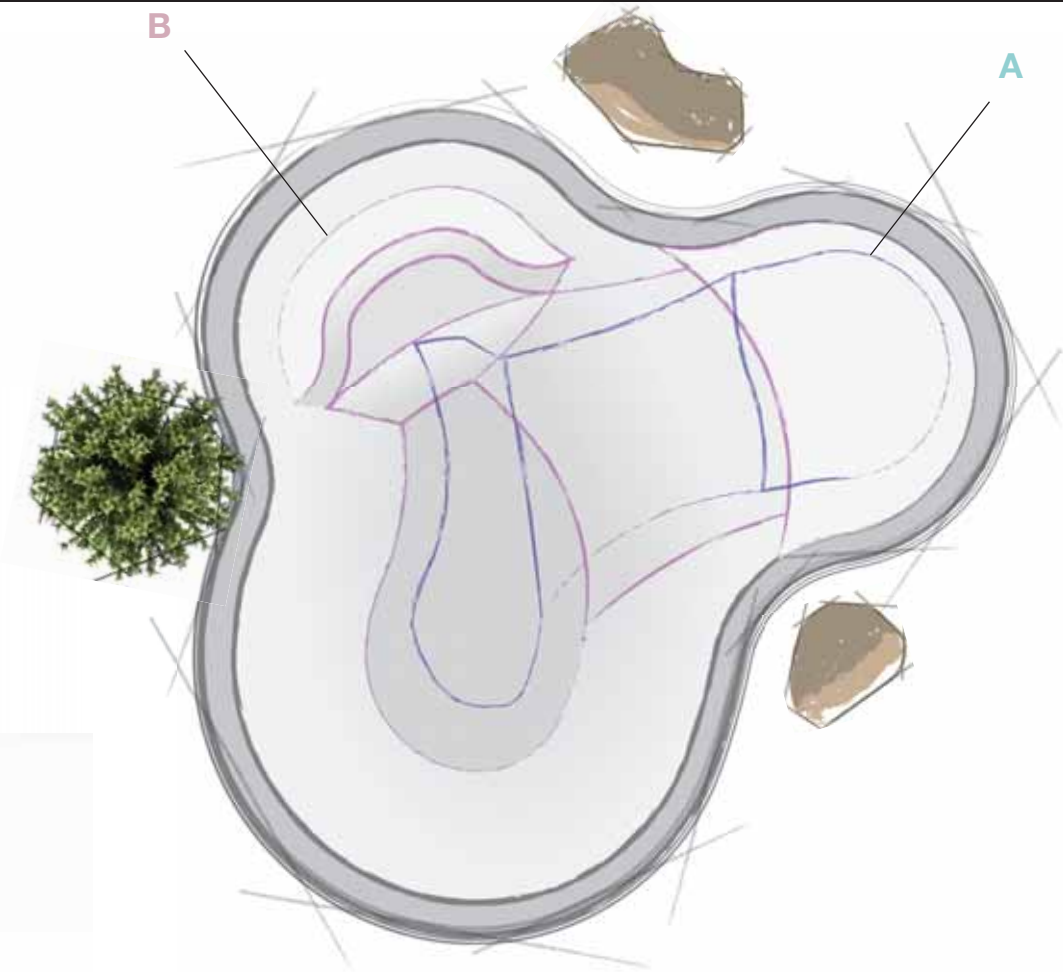

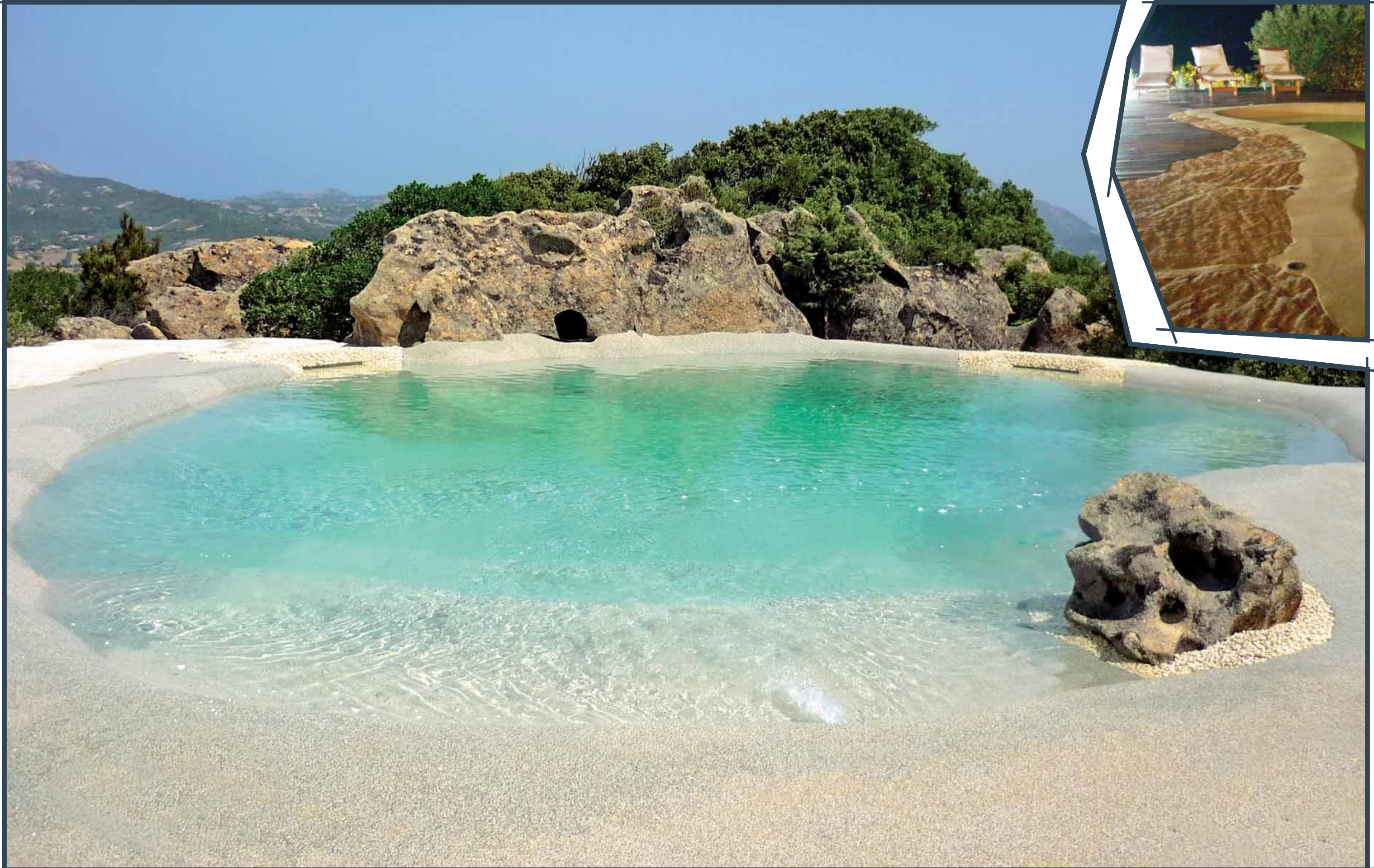

TP 03

This model has an always much appreciated classical shape. In the smaller sizes the beach is frontal and ideal for children to play or for sunbathing. In contrast, for the larger sizes a lateral beach is recommended so as to favour a swimming line along the full length. In this case we also recommend creating two different depths on the long side (minimum depth recommended for recreational swimming 100cm).

	A			B			C			D		
type	1	2	3	4	5	6	7	8	9	10	11	12
length	5,00	6,64	7,98	9,13	10,57	11,51	12,38	13,19	13,98	14,68	15,38	16,04
width	3,70	4,90	5,85	6,67	7,12	7,73	8,33	8,86	9,37	9,83	10,29	10,72
max water depth	1,1	1,2	1,3	1,4	1,5	1,6	1,6	1,6	1,6	1,6	1,6	1,6
	✓	✓	✓	✓	✓	✓	✓	✓	✓	✓	✓	✓

The dimensions are expressed in meters. Length and width are inclusive of the 30cm outer edge.

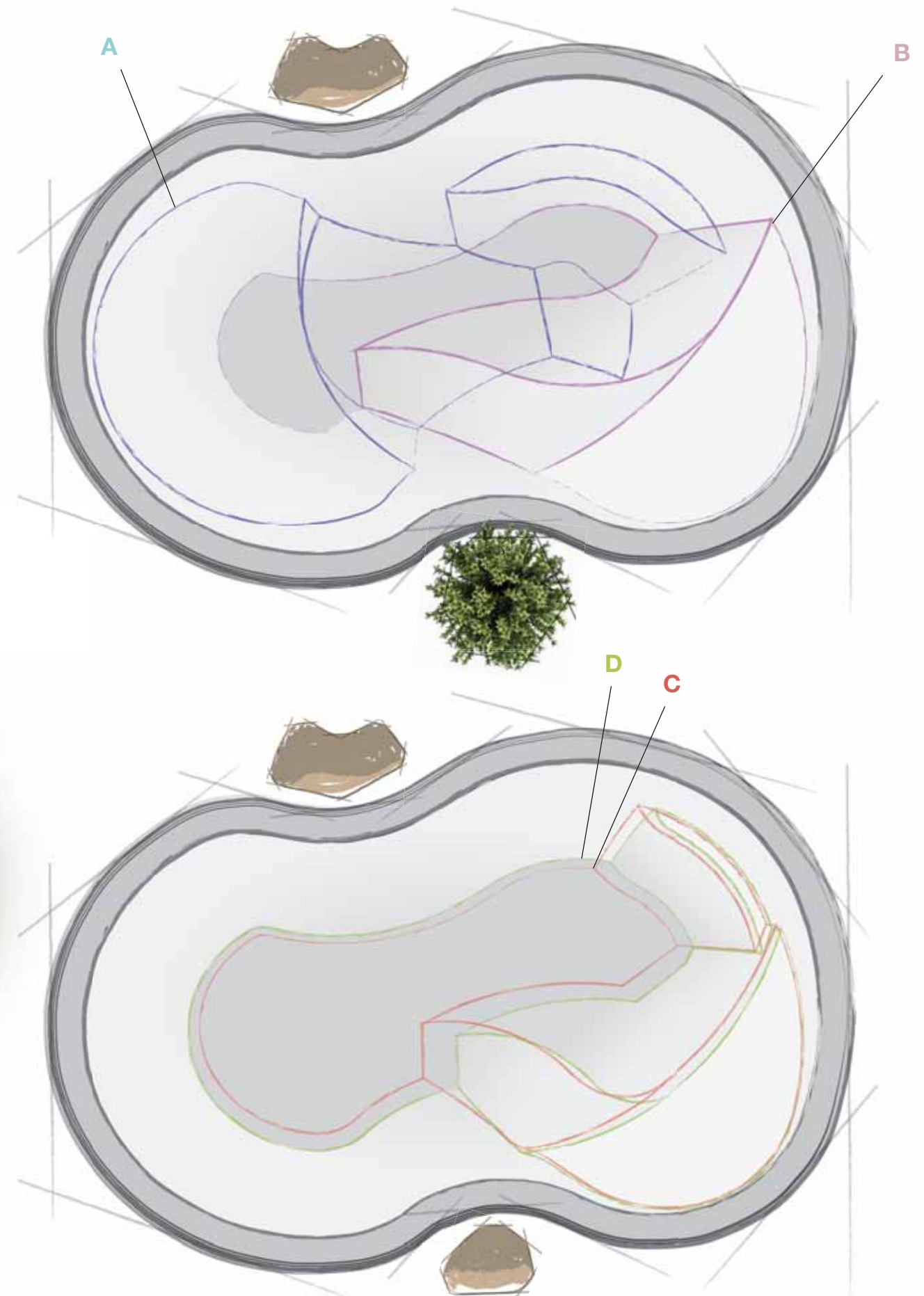
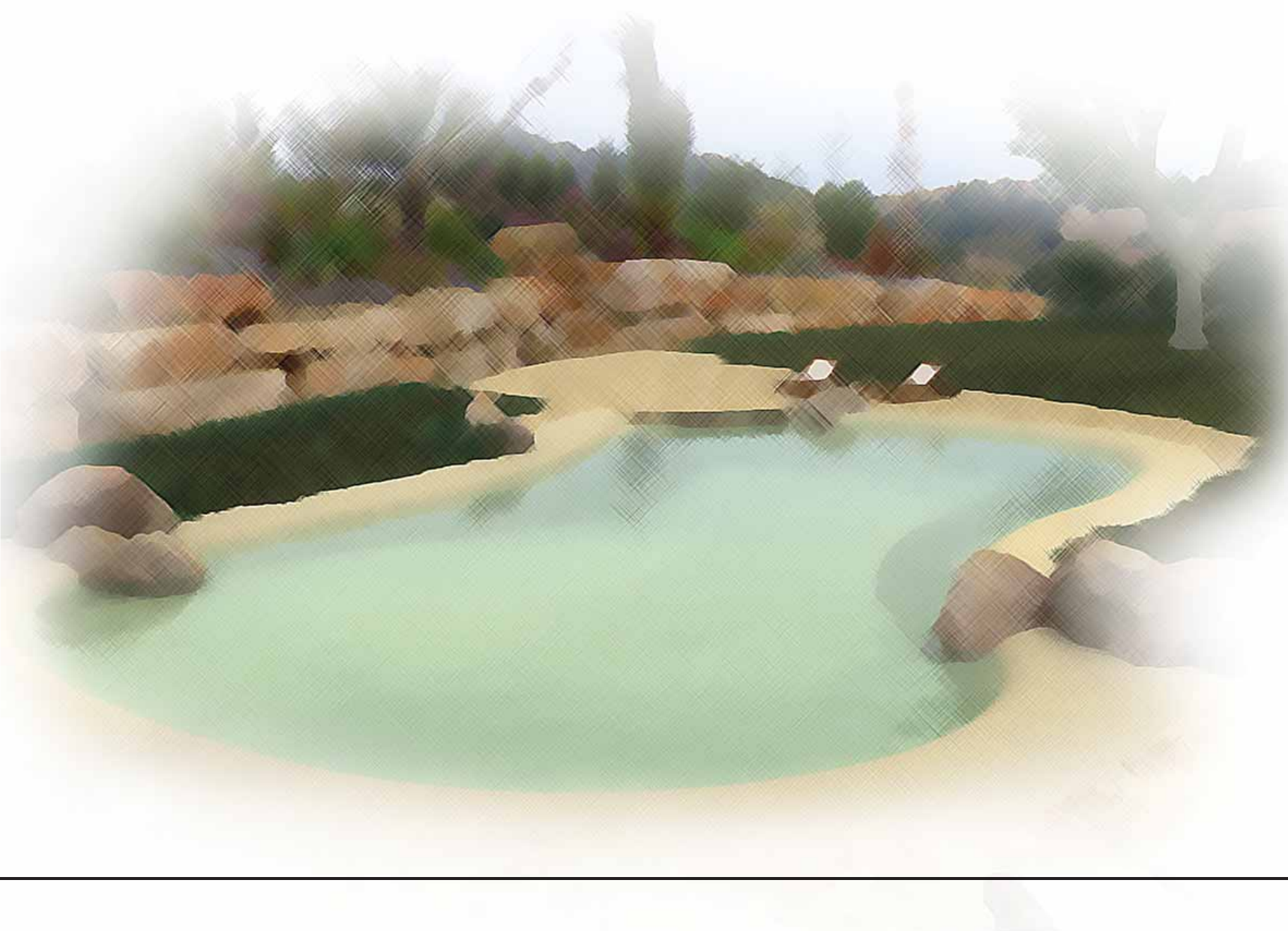



TP 04

This model offers a very natural elongated shape as a result of the asymmetries of the perimeter. The small models differ substantially from the larger models due to the positioning of the beach so as to optimize the long side for swimming. In several places it is possible to create seats on the pool edge so as to find the correct position in favour of the sun whether in the morning or in the afternoon.

	A			B			C			D		
type	1	2	3	4	5	6	7	8	9	10	11	12
length	5,48	7,45	8,87	10,12	11,23	12,23	13,18	14,06	14,87	15,62	16,37	17,10
width	3,85	5,15	6,11	6,98	7,72	8,40	9,03	9,62	10,16	10,67	11,17	11,65
max water depth	1,1	1,2	1,3	1,4	1,5	1,6	1,6	1,6	1,6	1,6	1,6	1,6
	✓	✓	✓	✓	✓	✓	✓	✓	✓	✓	✓	✓

The dimensions are expressed in meters. Length and width are inclusive of the 30cm outer edge.

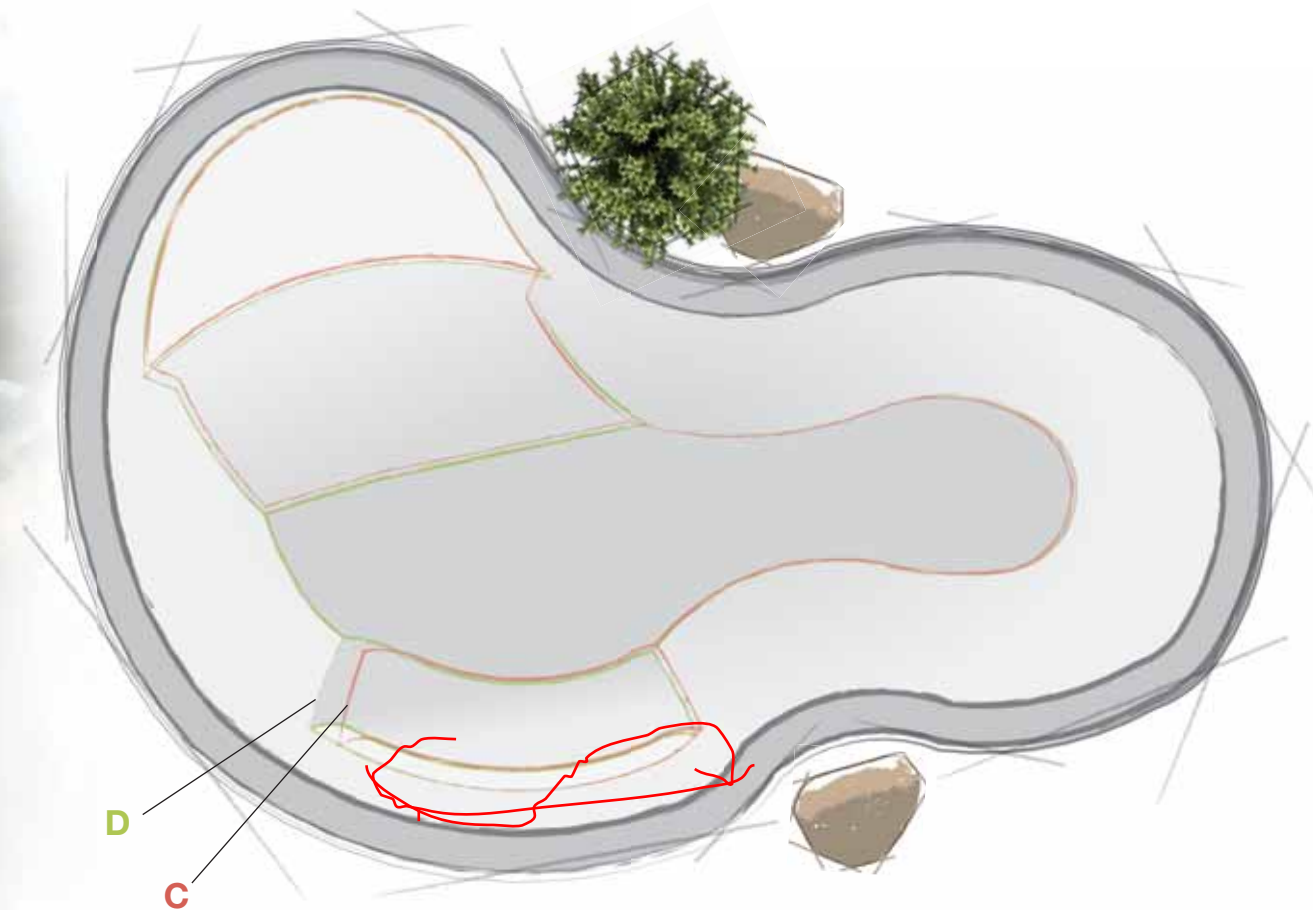
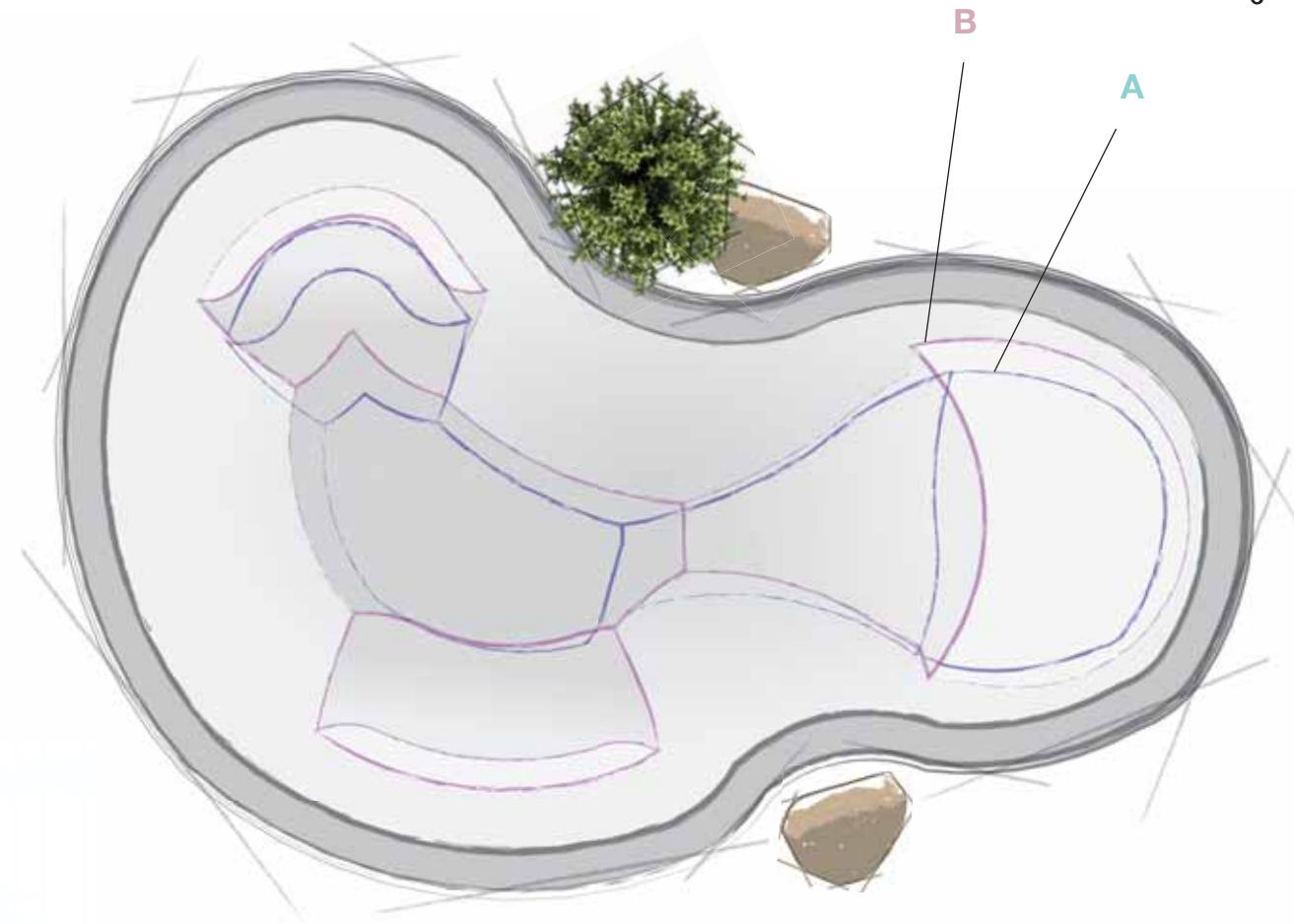



TP 05

This model has a complex elongated shape that must embrace the main view, usually the building. The central inlet can accommodate a small beach or comfortable air therapy chaises longues. It is a very interesting shape because it offers different areas of relaxation spaced apart, which provide space for all swimmers and bathers. Changes in depth are also recommended on the long side (minimum depth recommended for recreational swimming 100cm) for this model.

	A			B			C			D		
type	1	2	3	4	5	6	7	8	9	10	11	12
length	-	7,17	8,57	10,26	11,42	12,40	13,37	14,23	15,06	15,84	16,60	17,30
width	-	4,62	5,49	6,26	6,95	7,52	8,09	8,60	9,07	9,54	9,98	10,40
max water depth	-	1,2	1,3	1,4	1,5	1,6	1,6	1,6	1,6	1,6	1,6	1,6
	X	✓	✓	✓	✓	✓	✓	✓	✓	✓	✓	✓

The dimensions are expressed in meters. Length and width are inclusive of the 30cm outer edge.

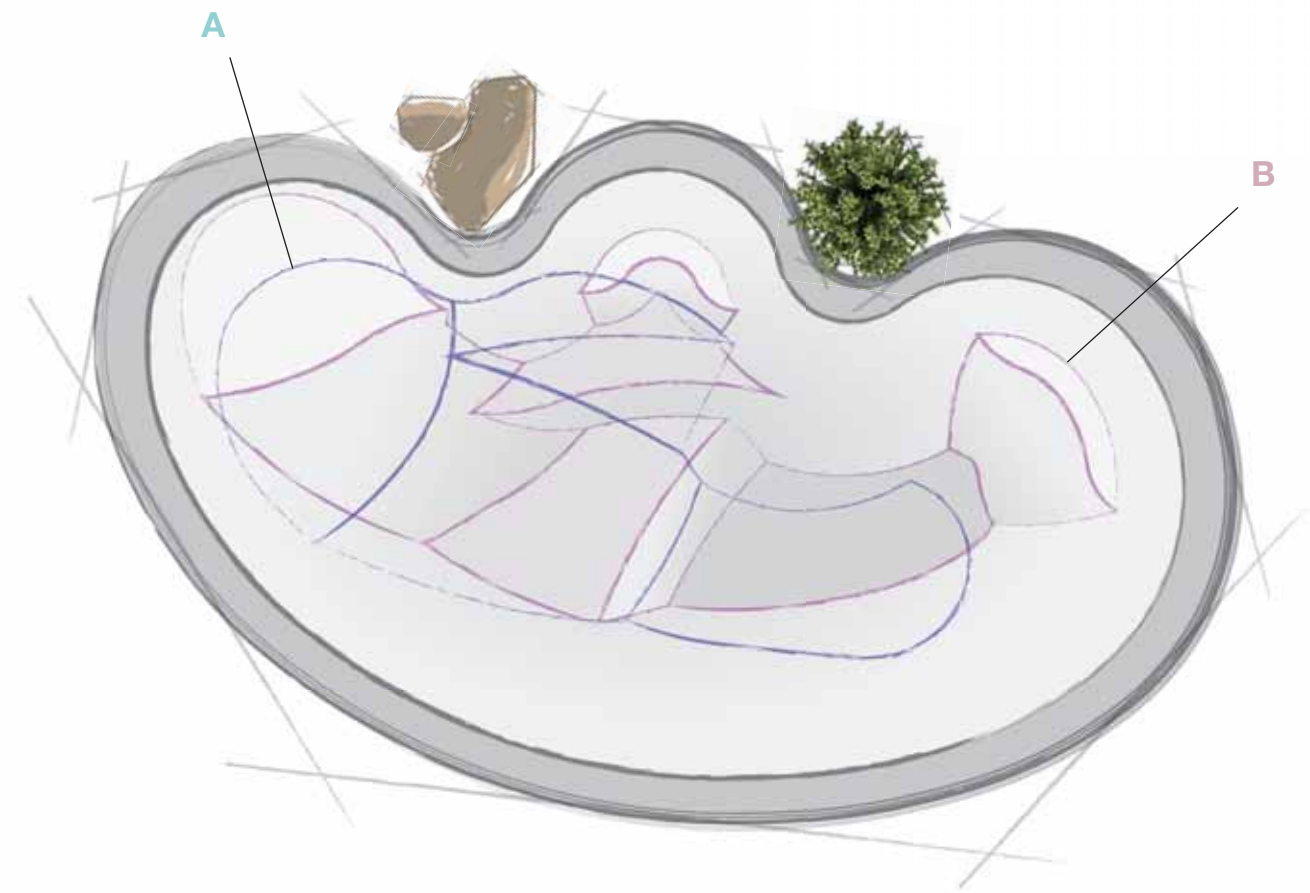



TP 06

This model has a much appreciated shape. In the smaller sizes the beach is frontal and ideal for children to play or for sunbathing. In contrast, in the larger sizes we recommend a lateral beach so as to favour a swimming line along the total length. In this case we also recommend creating two different depths on the long side. Attention must be paid to the orientation of the pool: the pool must face and embrace the main viewpoint.

	A			B			C			D		
type	1	2	3	4	5	6	7	8	9	10	11	12
length	-	7,13	8,99	10,18	11,31	12,35	13,30	14,17	14,97	15,74	16,49	17,20
width	-	4,47	5,35	6,22	6,88	7,50	8,06	8,57	9,04	9,49	9,93	10,35
max water depth	-	1,2	1,3	1,4	1,5	1,6	1,6	1,6	1,6	1,6	1,6	1,6
	X	✓	✓	✓	✓	✓	✓	✓	✓	✓	✓	✓

The dimensions are expressed in meters. Length and width are inclusive of the 30cm outer edge.

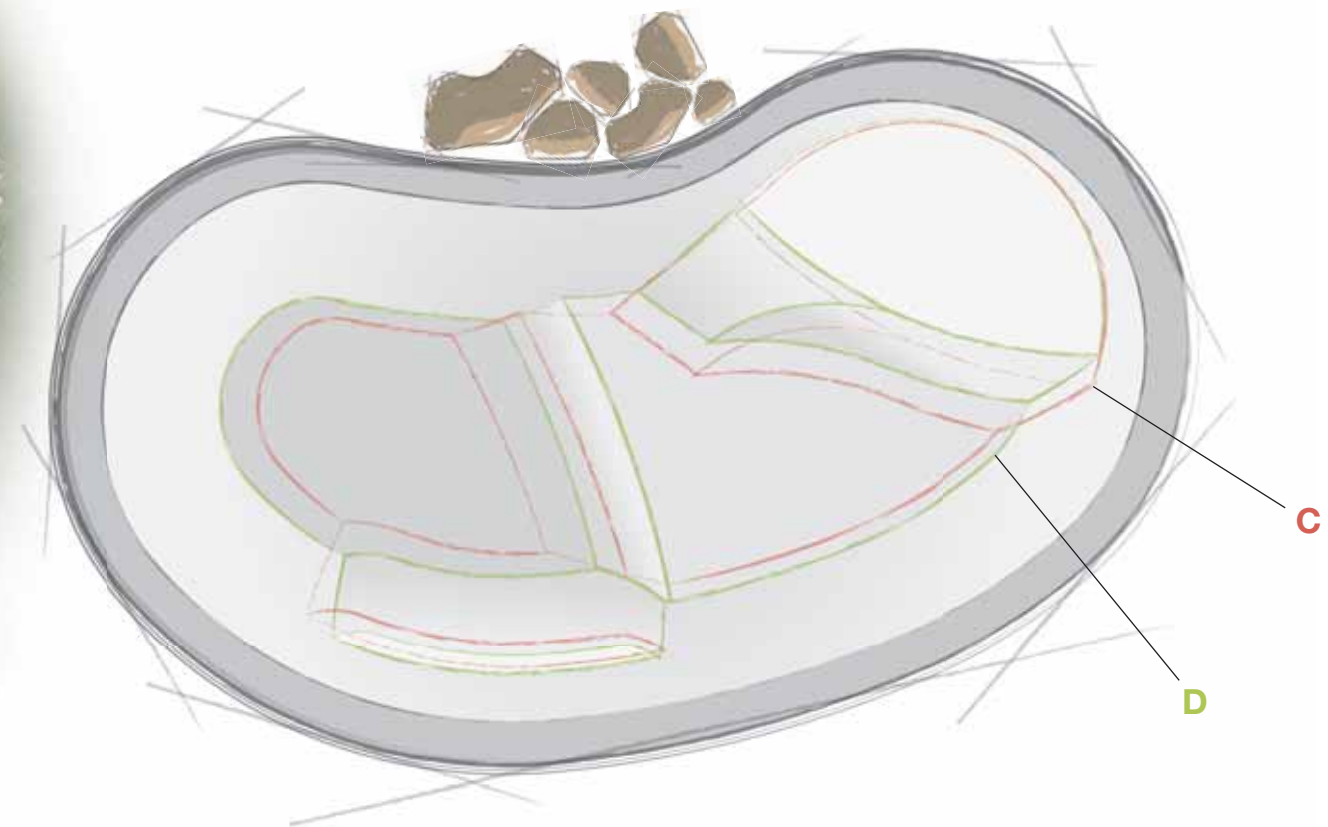
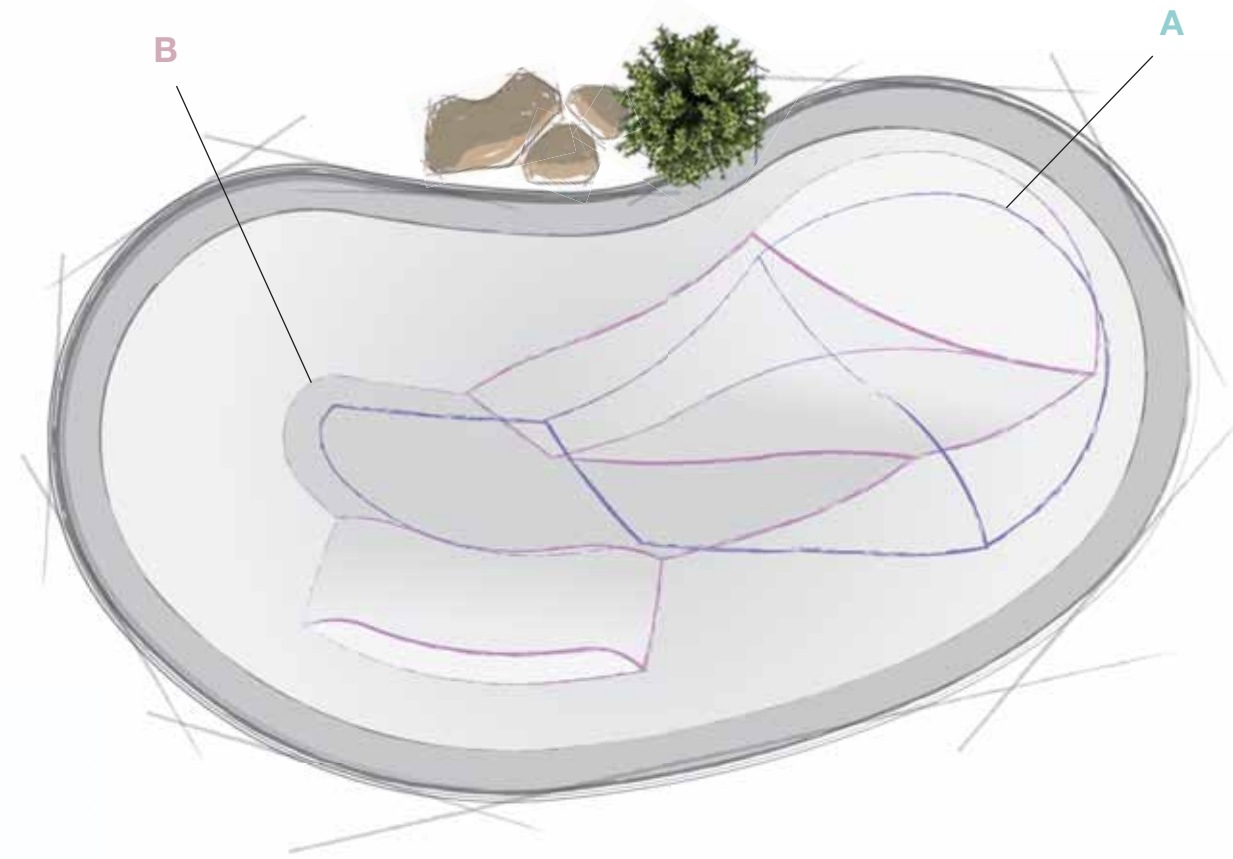



TP 07

Model with a very natural elongated shape.

The junction between the beach and pool bed may have steps or an inclined plane. The beach can be made even more independent with monoliths at the ends, even better if they are partially submerged. Seats in the area opposite the beach are recommended without invading the space dedicated to swimming.

	A			B			C			D		
type	1	2	3	4	5	6	7	8	9	10	11	12
length	-	-	9,65	11,01	11,68	12,75	13,71	14,61	15,45	16,25	17,03	17,74
width	-	-	5,12	5,79	6,66	7,25	7,78	8,27	8,73	9,17	9,59	9,99
max water depth	-	-	1,3	1,4	1,5	1,6	1,6	1,6	1,6	1,6	1,6	1,6
	X	X	✓	✓	✓	✓	✓	✓	✓	✓	✓	✓

The dimensions are expressed in meters. Length and width are inclusive of the 30cm outer edge.

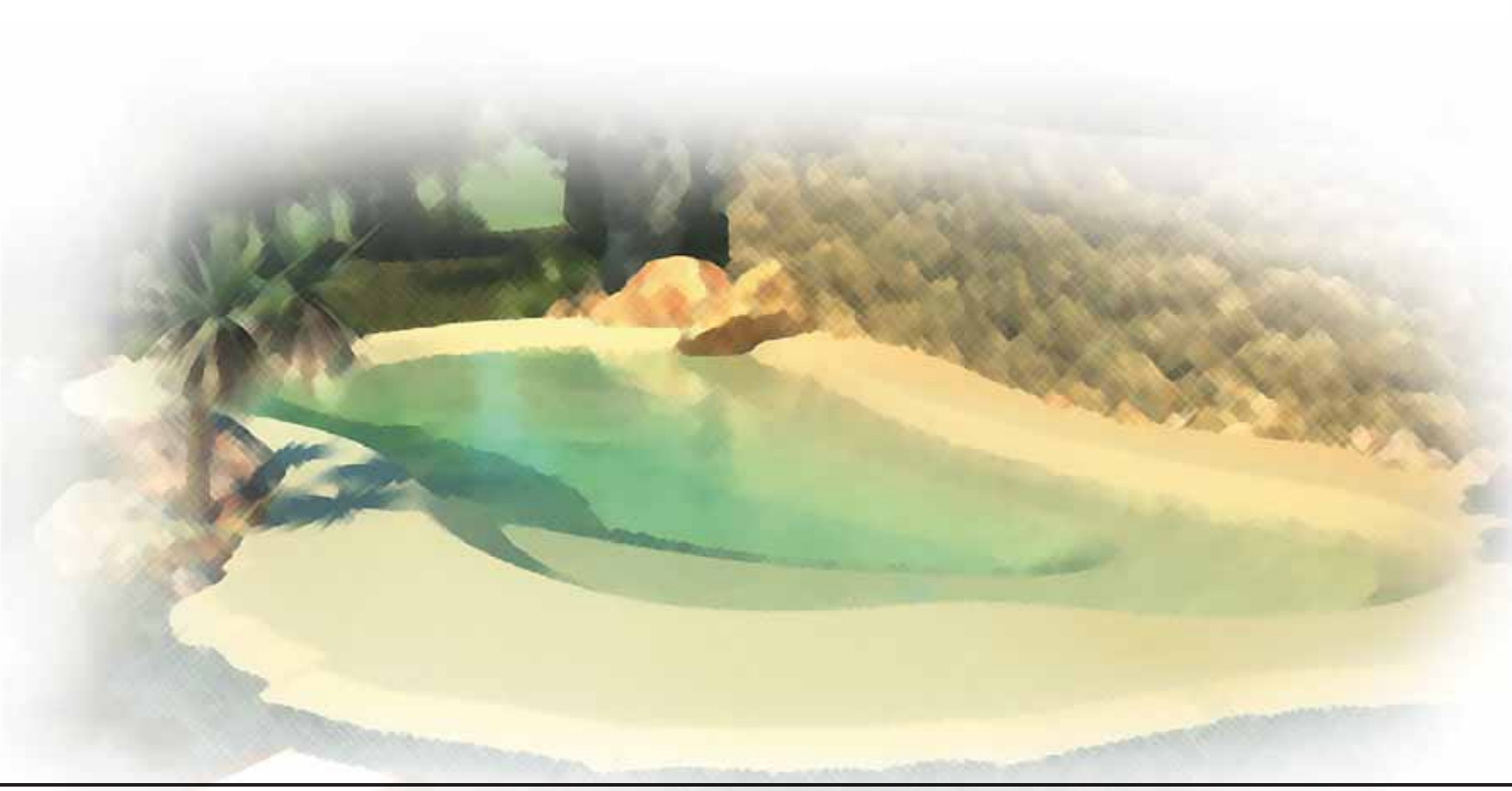
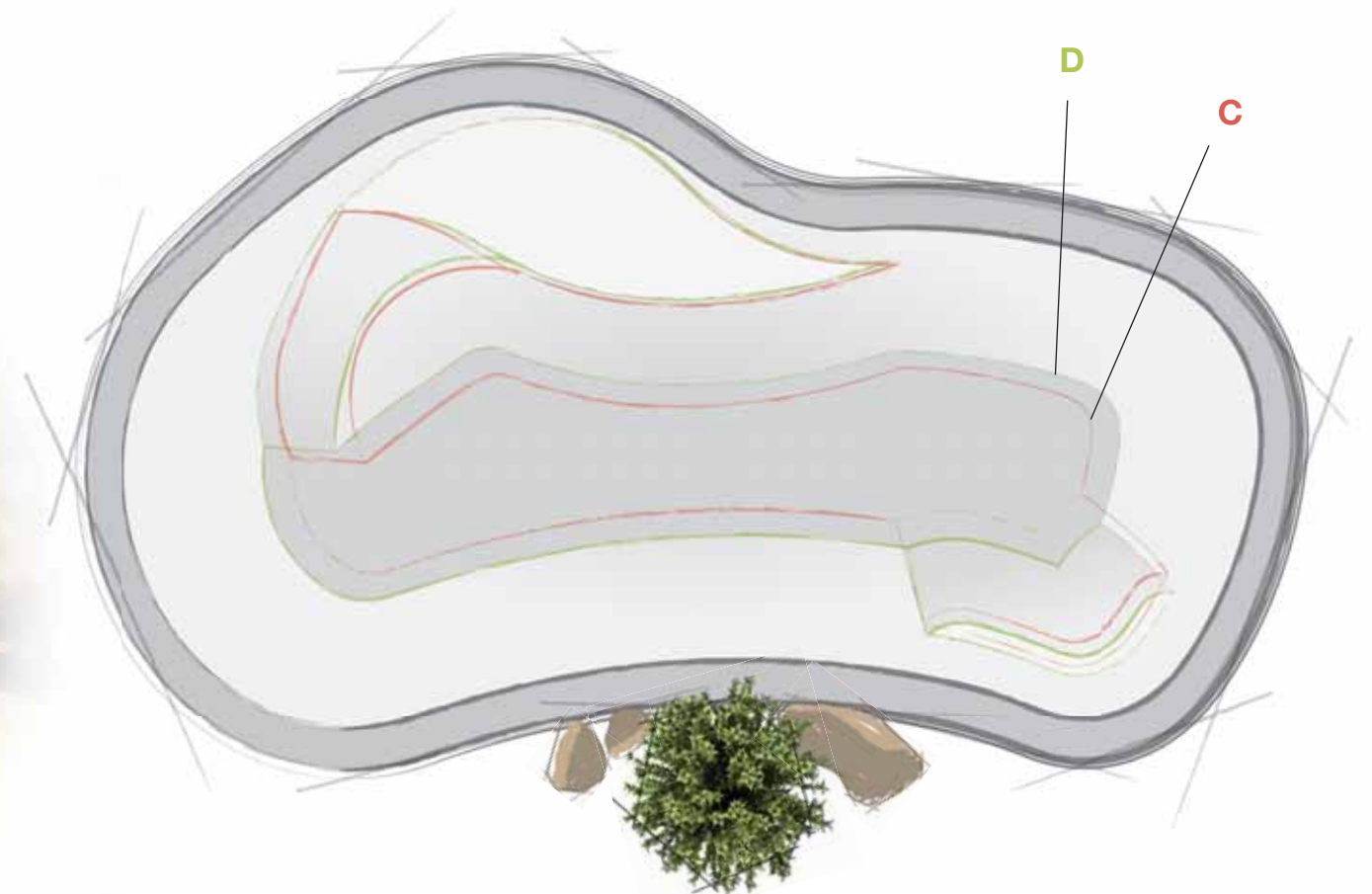
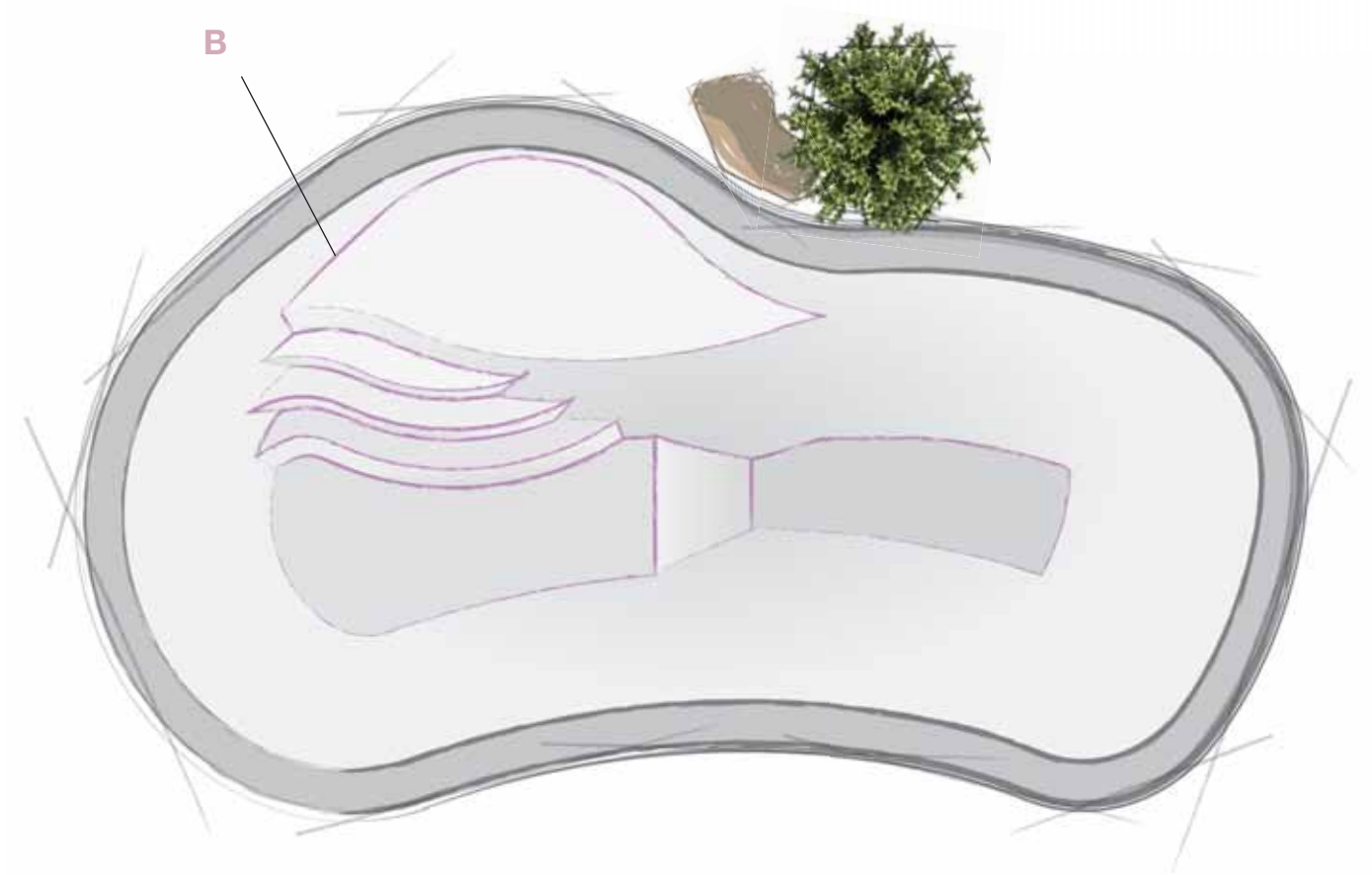



TP 08

This shape allows the creation of two nearly separate basins. One which is wider for relaxation and a narrower one that can be dedicated to additional seats, a shallower children's play area, or the entire length can be dedicated to swimming. It is an ideal model to create outdoor solariums.

	A			B			C			D		
type	1	2	3	4	5	6	7	8	9	10	11	12
length	-	-	9,24	10,56	12,69	13,86	14,93	15,91	16,84	17,70	18,55	19,36
width	-	-	5,96	6,78	7,63	8,31	8,93	9,50	10,04	10,54	11,04	11,50
max water depth	-	-	1,3	1,4	1,5	1,6	1,6	1,6	1,6	1,6	1,6	1,6
	X	X	✓	✓	✓	✓	✓	✓	✓	✓	✓	✓

The dimensions are expressed in meters. Length and width are inclusive of the 30cm outer edge.

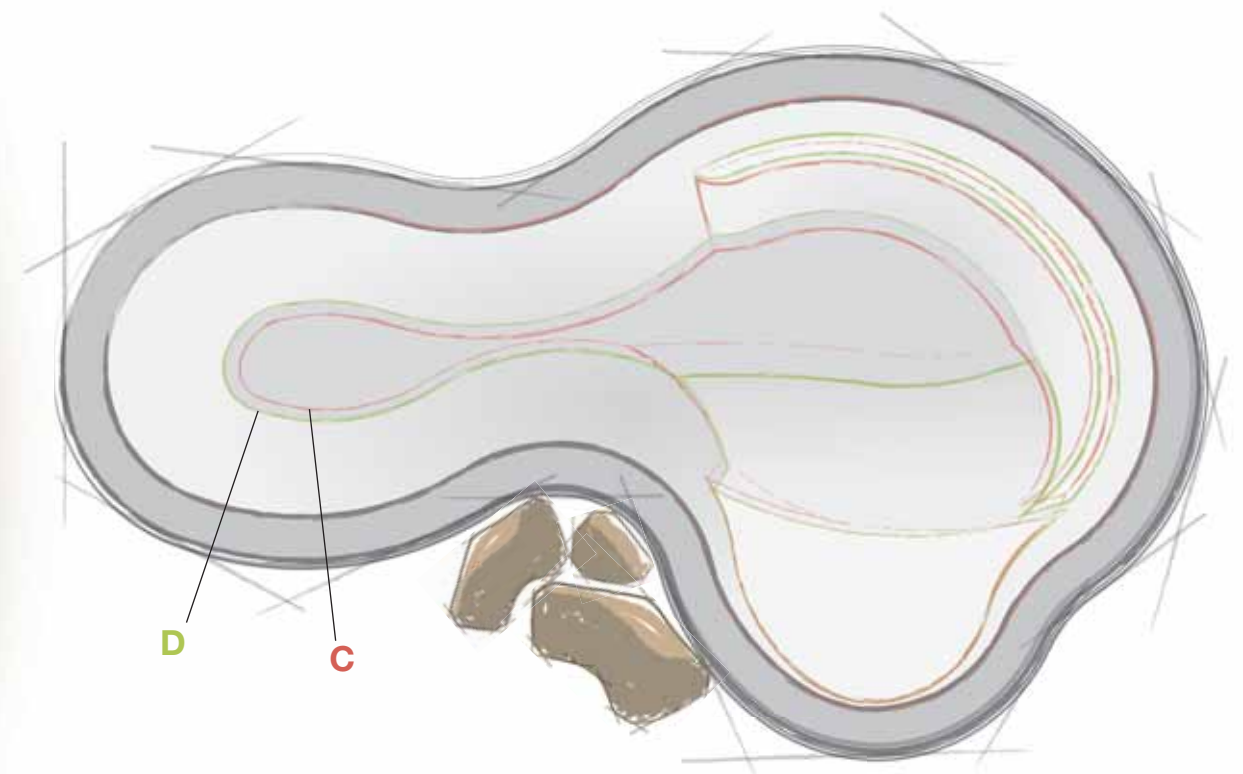



TP 09

This model is the ideal shape in all cases where it is necessary to respect a straight line. The beach and built-in seats must favour the position of the sun. This shape respects adequate proportions between swimming, beach, and relaxation areas. Everyone can find their niche here. Along the straight line a paved sunbathing area is ideal.

	A			B			C			D		
type	1	2	3	4	5	6	7	8	9	10	11	12
length	5,32	7,27	8,81	10,23	11,32	12,37	13,30	14,03	14,84	15,62	16,37	17,04
width	3,10	4,13	4,95	5,58	6,15	6,69	7,17	8,05	8,50	8,93	9,35	9,72
max water depth	1,1	1,2	1,3	1,4	1,5	1,6	1,6	1,6	1,6	1,6	1,6	1,6
	✓	✓	✓	✓	✓	✓	✓	✓	✓	✓	✓	✓

The dimensions are expressed in meters. Length and width are inclusive of the 30cm outer edge.

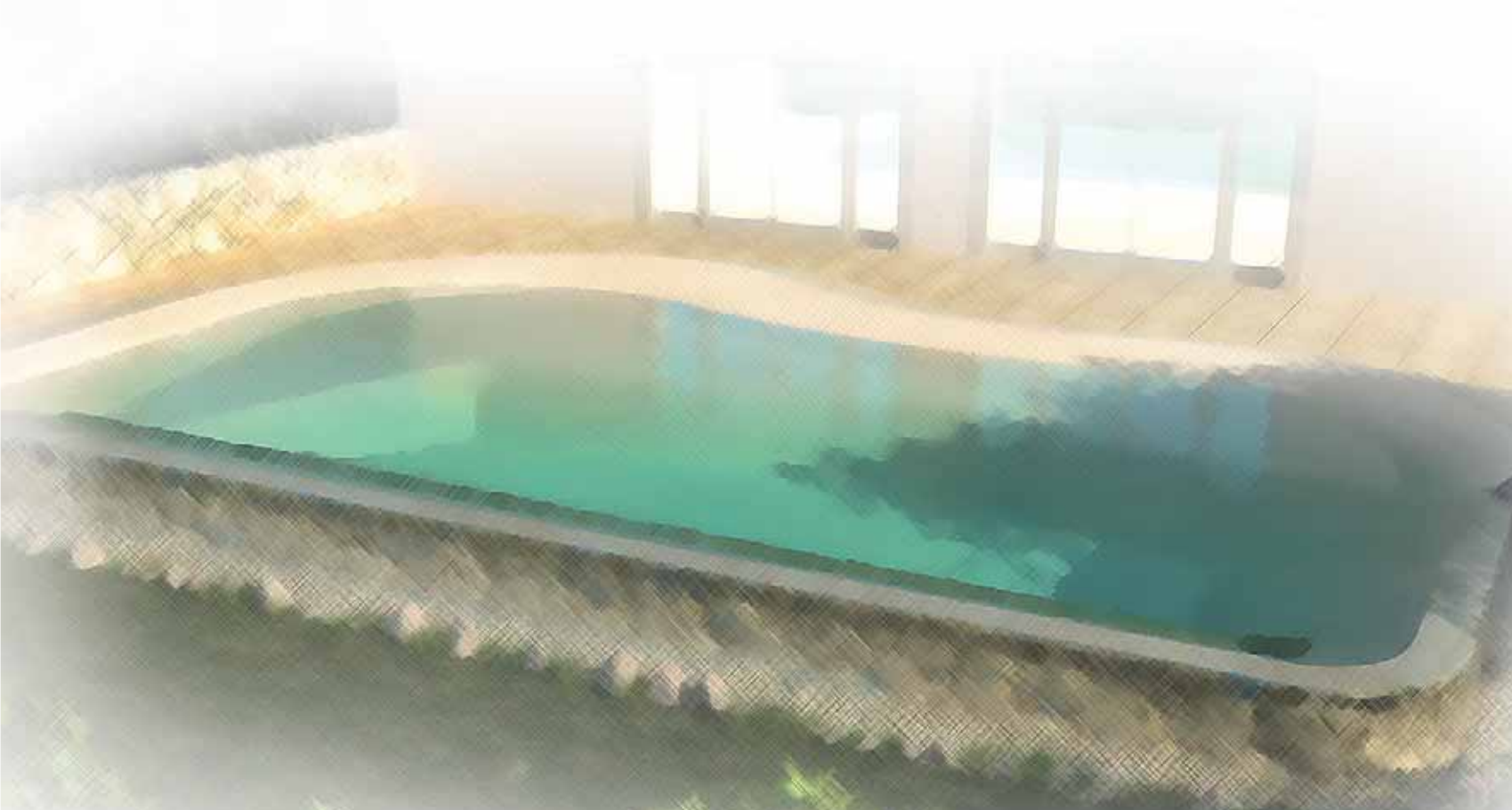
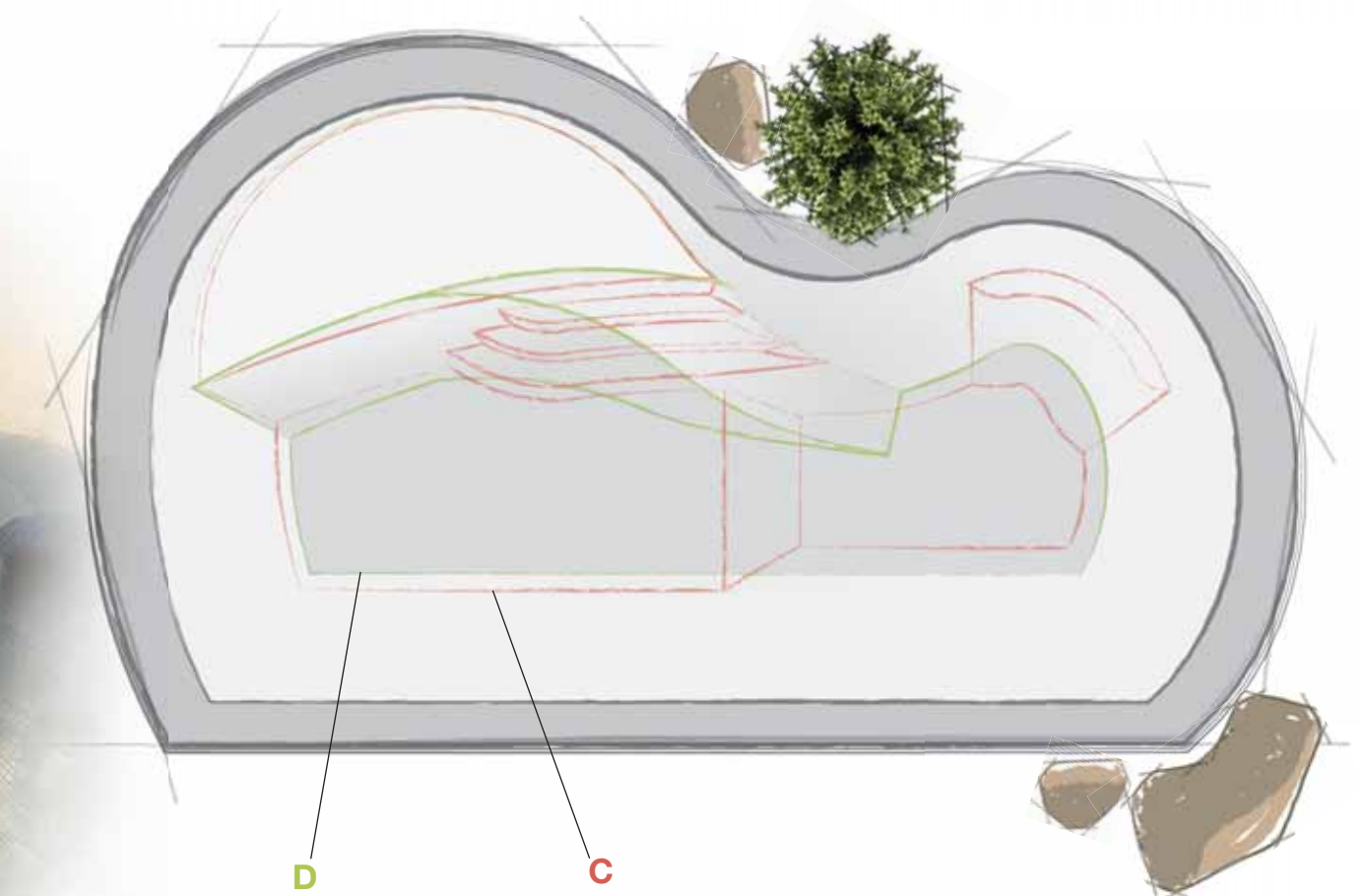
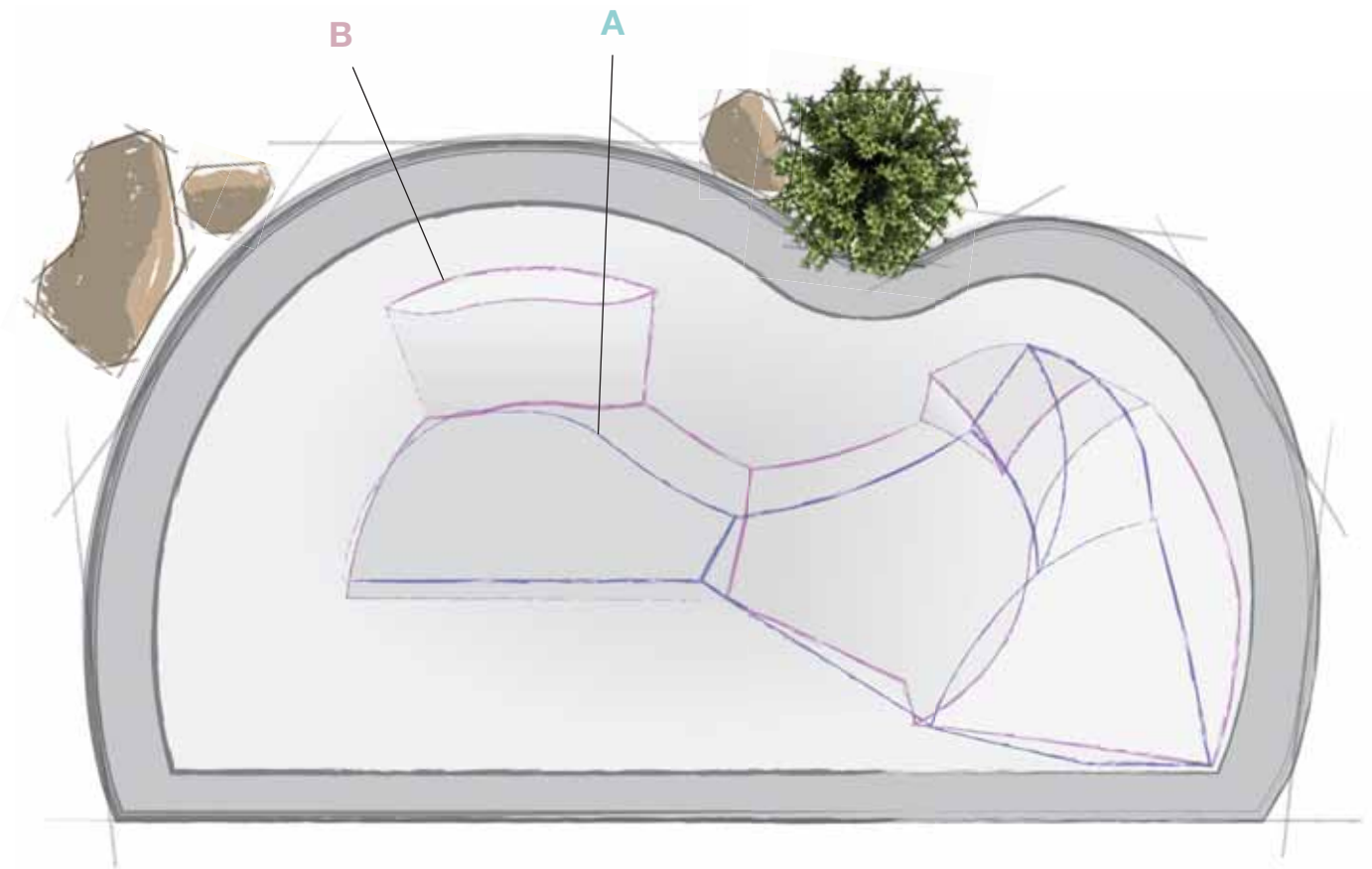



TP 10

This shape arose from the need to exploit a corner of the garden or at least provide a shape that complies with the geometries of the context. The shape enables the creation of beaches or seats on all the ends and in the larger sizes it is possible to create a swimming area.

	A			B			C			D		
type	1	2	3	4	5	6	7	8	9	10	11	12
length	4,45	6,02	7,25	8,29	9,20	10,02	10,75	11,44	12,13	12,73	13,34	13,89
width	4,02	5,41	6,51	7,43	8,23	8,96	9,61	10,22	10,83	11,37	11,91	12,40
max water depth	1,1	1,2	1,3	1,4	1,5	1,6	1,6	1,6	1,6	1,6	1,6	1,6
	✓	✓	✓	✓	✓	✓	✓	✓	✓	✓	✓	✓

The dimensions are expressed in meters. Length and width are inclusive of the 30cm outer edge.

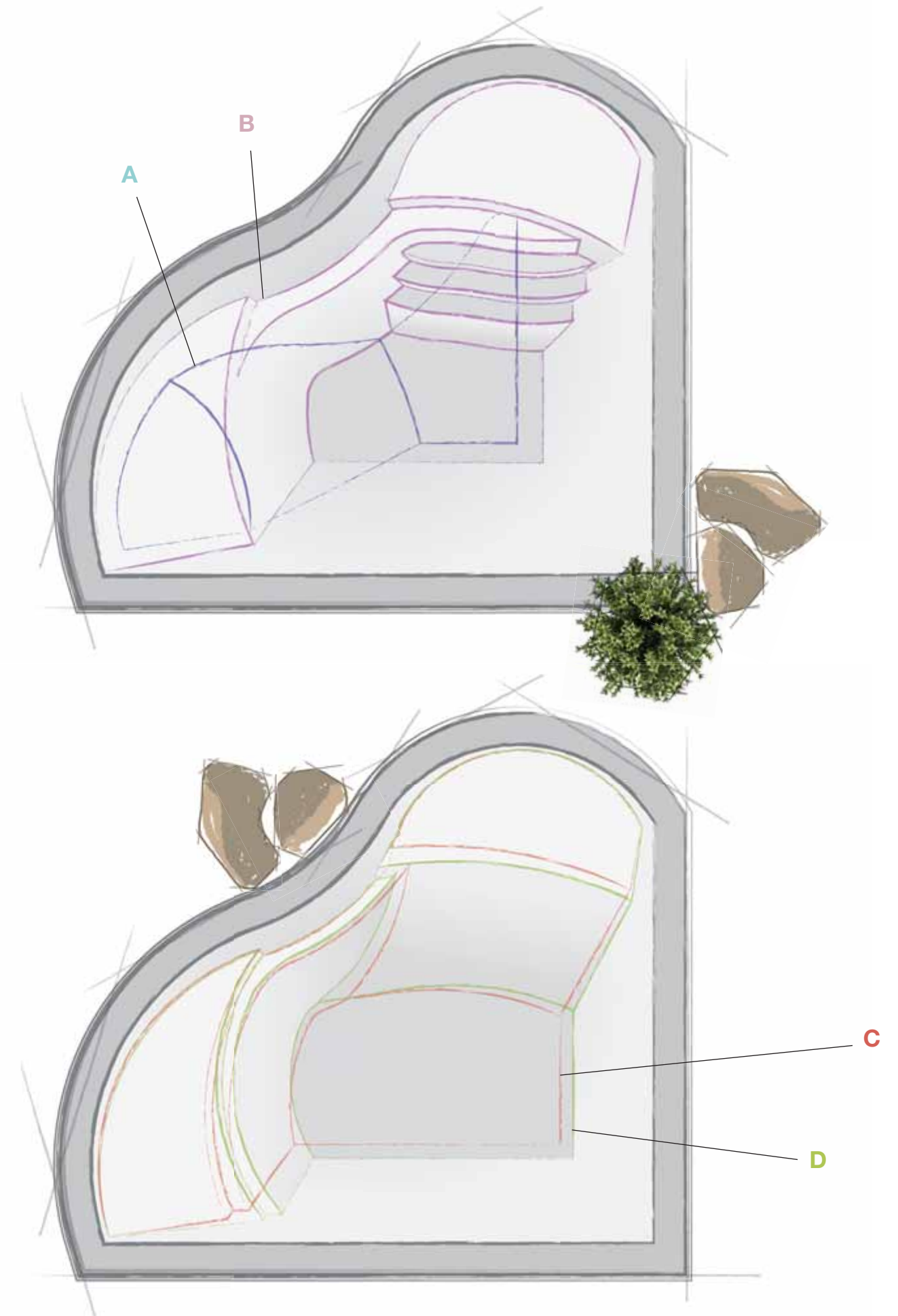



TP 11

This shape arose from the need to respect existing architectural geometries without giving up a perfectly furnished environment with beach, seats, and swimming areas.

	A			B			C			D		
type	1	2	3	4	5	6	7	8	9	10	11	12
length	4,34	5,68	6,87	7,80	8,63	9,40	10,13	10,78	11,39	11,99	12,54	13,06
width	3,50	4,54	5,45	6,17	6,82	7,41	7,98	8,78	8,96	9,42	9,84	10,25
max water depth	1,1	1,2	1,3	1,4	1,5	1,6	1,6	1,6	1,6	1,6	1,6	1,6
	✓	✓	✓	✓	✓	✓	✓	✓	✓	✓	✓	✓

The dimensions are expressed in meters. Length and width are inclusive of the 30cm outer edge.

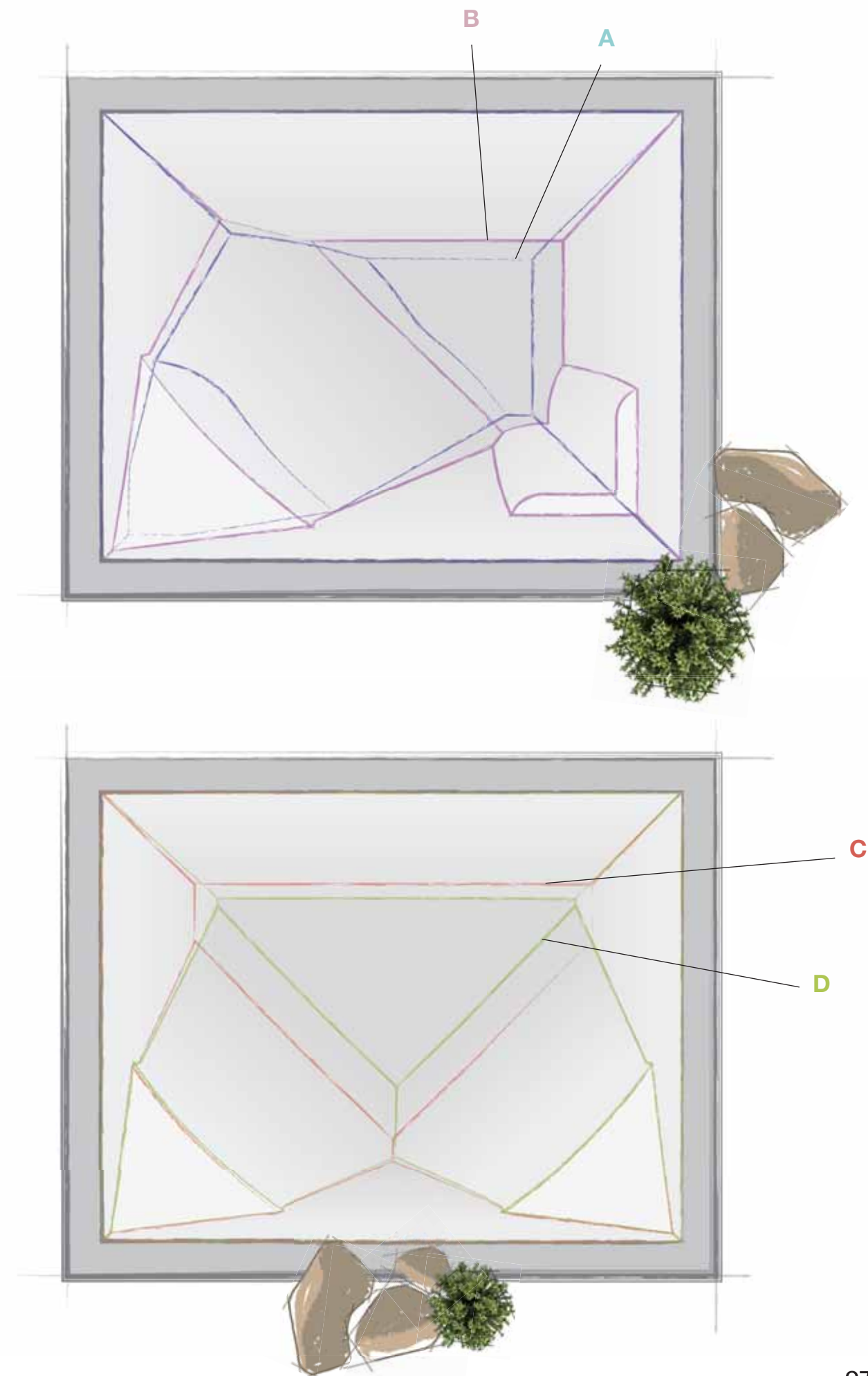
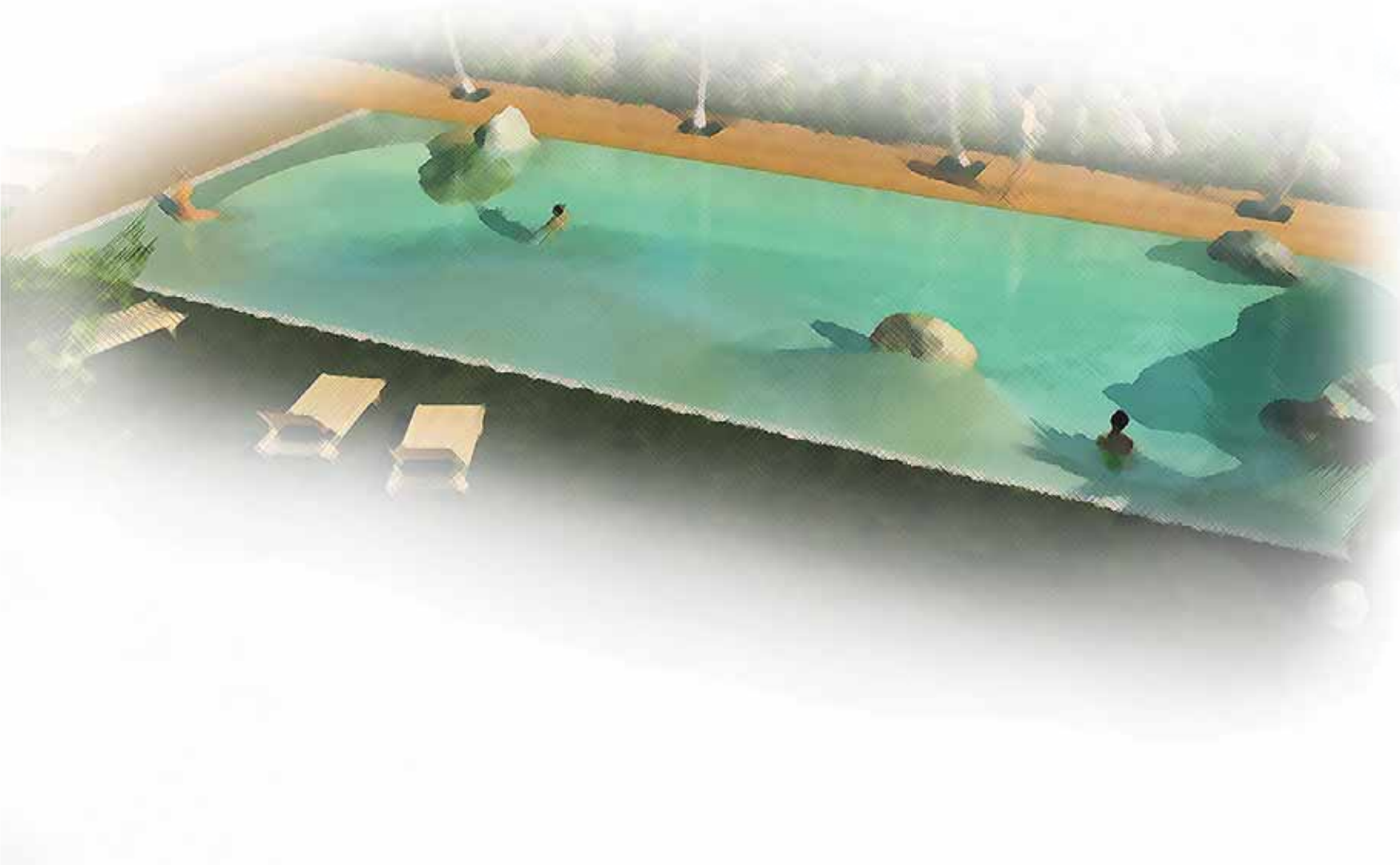



TP 12

This shape arose from a design in which it was necessary to create a small pool for children that could also be used as a hydro-massage sitting area and which has a small rise before the change in depth. This shape does not lend itself to small size pools.

	A			B			C			D		
type	1	2	3	4	5	6	7	8	9	10	11	12
length	-	6,98	8,43	10,06	11,23	12,15	13,10	13,96	14,77	15,53	16,26	16,94
width	-	5,15	6,17	6,89	7,70	8,31	8,94	9,52	10,05	10,57	11,05	11,50
max water depth	-	1,2	1,3	1,4	1,5	1,6	1,6	1,6	1,6	1,6	1,6	1,6
	X	✓	✓	✓	✓	✓	✓	✓	✓	✓	✓	✓

The dimensions are expressed in meters. Length and width are inclusive of the 30cm outer edge.

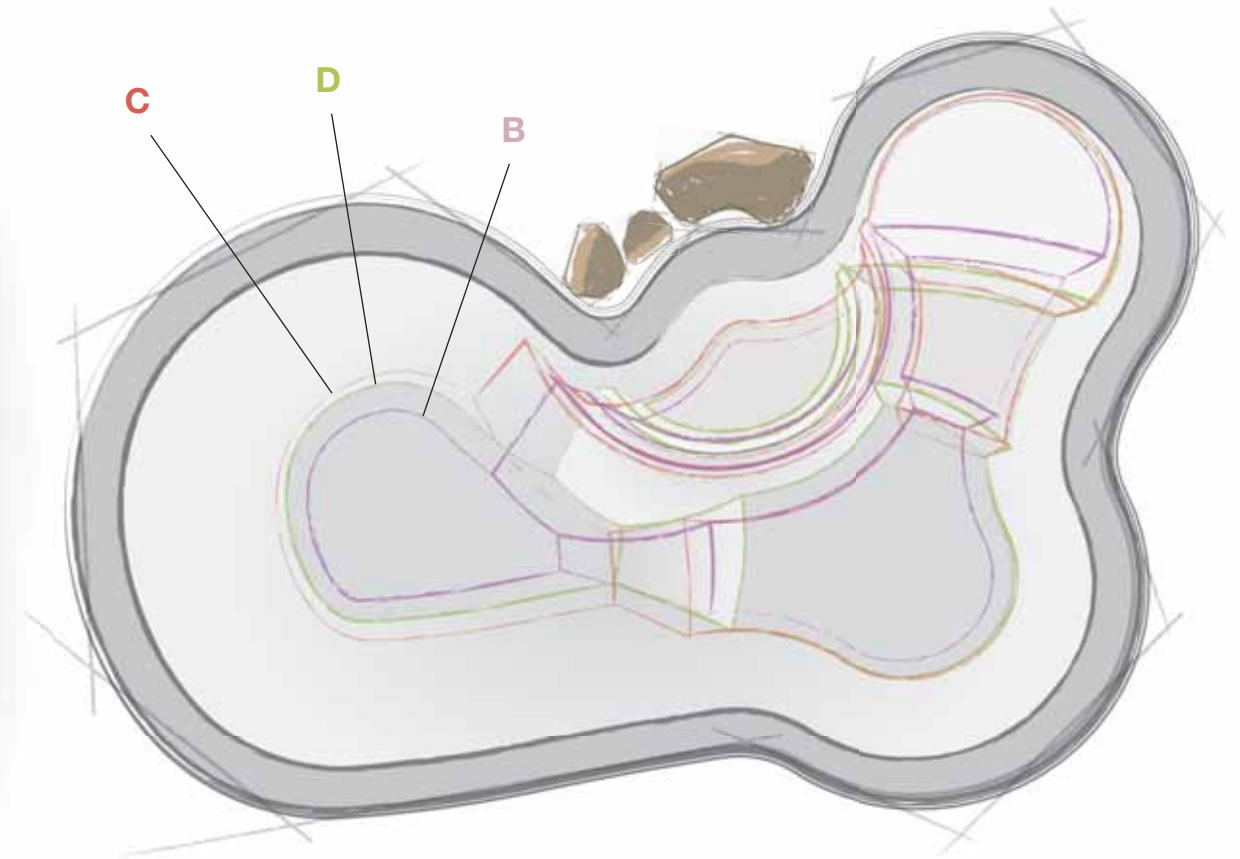
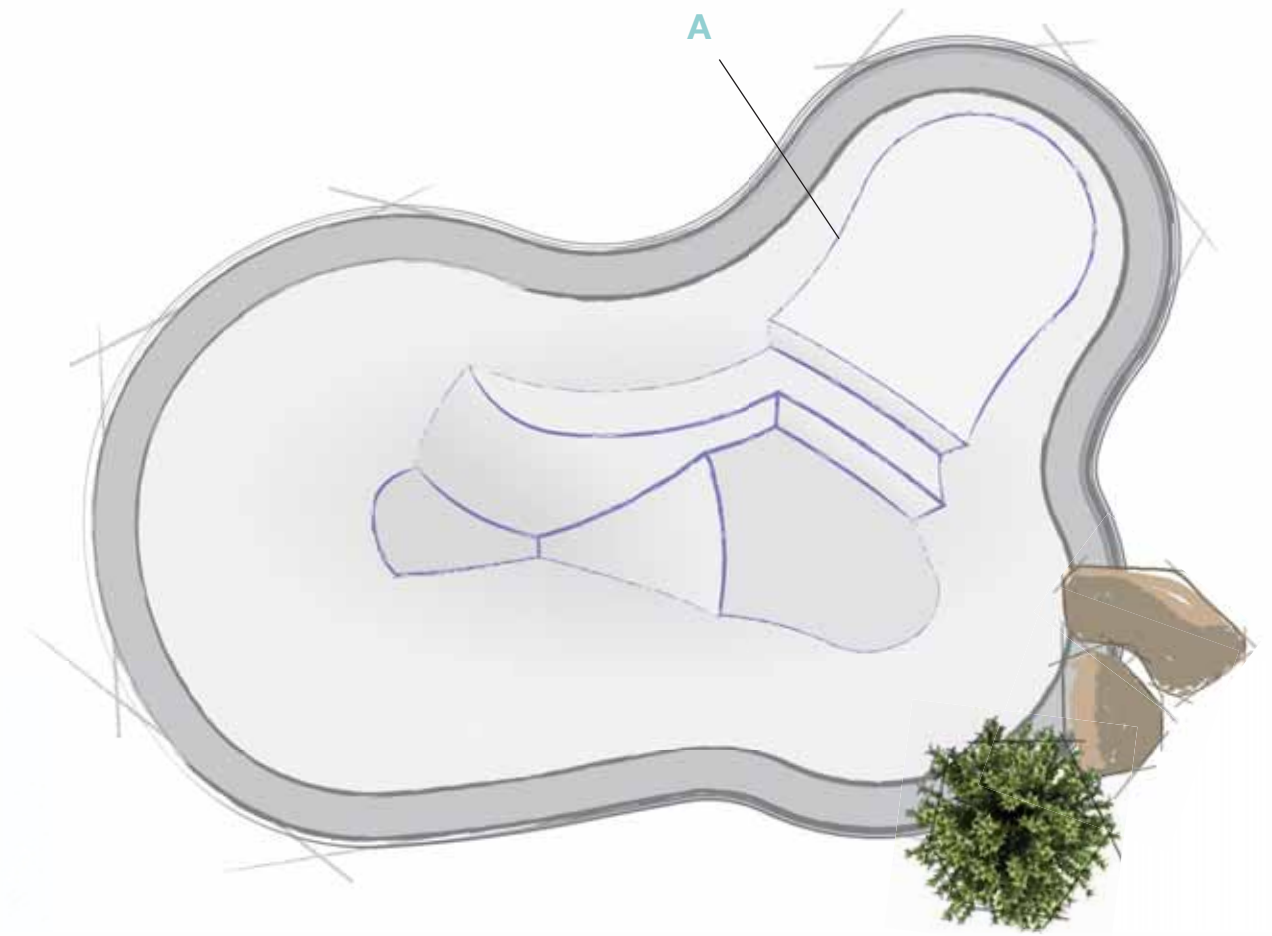



TP 13

This model has a helical shape that allows a clear separation of the various relaxation areas. It looks very different depending on the point of view. For this reason we recommend the creation of shrubby areas or the use of monoliths with paved sunbathing areas in the inlets. This model is the ideal shape for large sized pools.

	A			B			C			D		
type	1	2	3	4	5	6	7	8	9	10	11	12
length	-	-	-	-	11,33	12,37	12,86	13,70	14,50	15,32	16,02	16,71
width	-	-	-	-	9,45	10,30	10,86	11,56	12,23	13,10	13,70	14,29
max water depth	-	-	-	-	1,5	1,6	1,6	1,6	1,6	1,6	1,6	1,6
	X	X	X	X	✓	✓	✓	✓	✓	✓	✓	✓

The dimensions are expressed in meters. Length and width are inclusive of the 30cm outer edge.

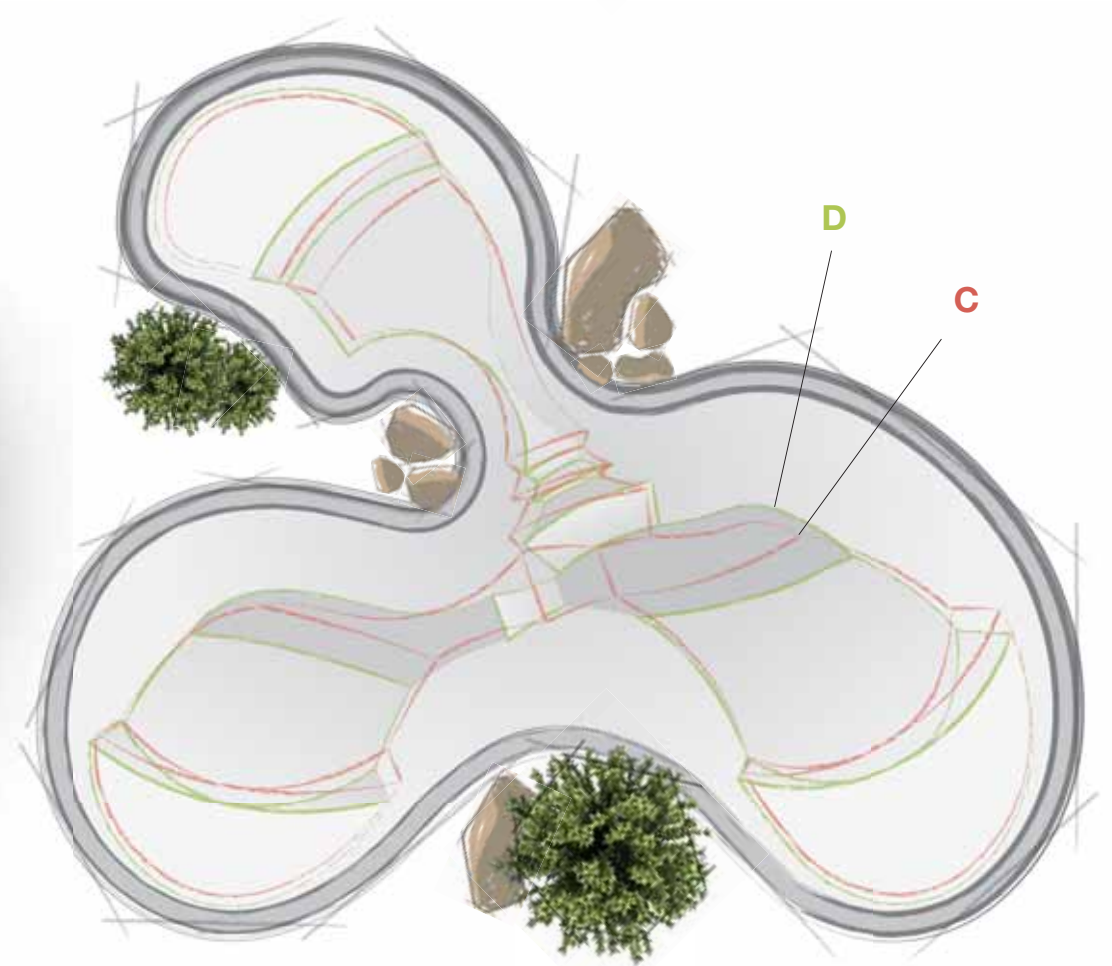
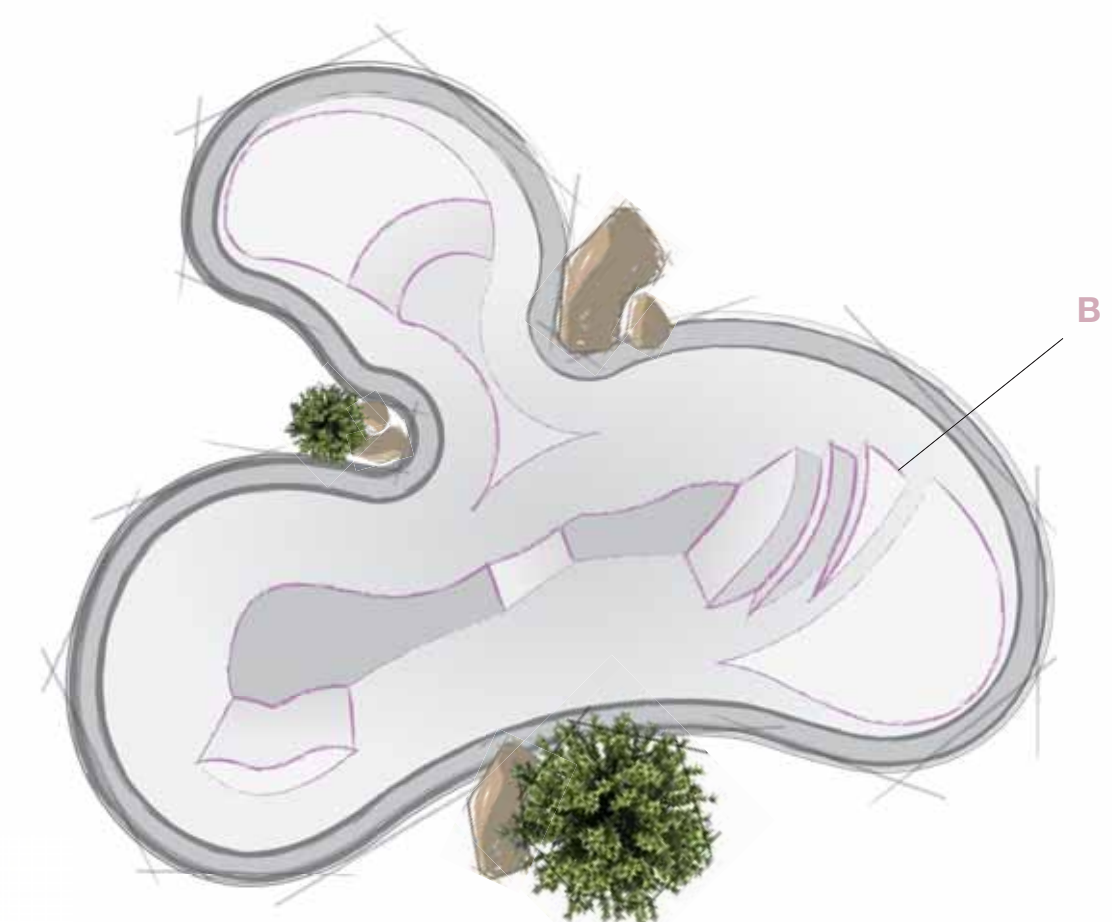
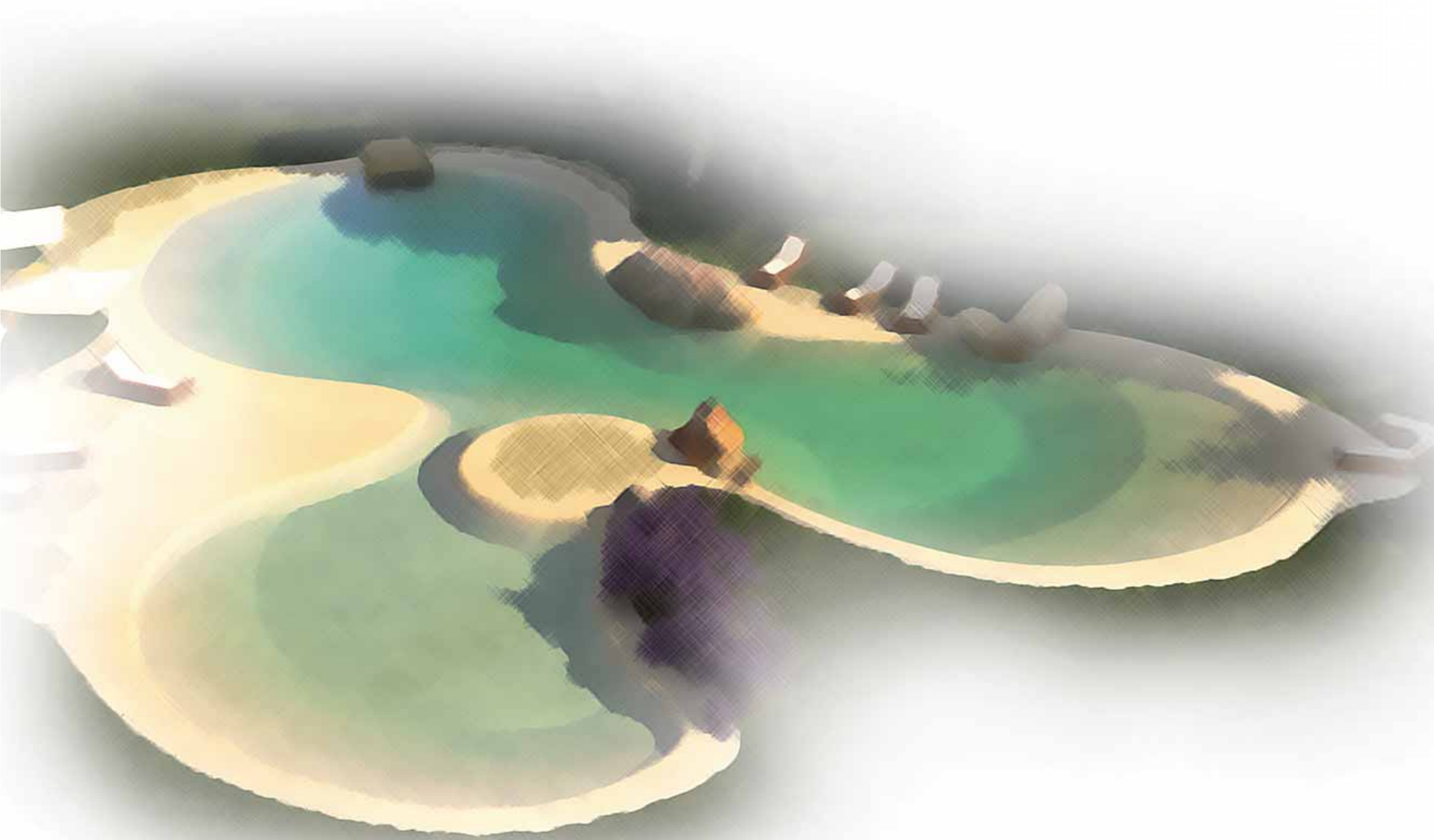



TP 14

This is a nearly rectangular model possibly with a double beach. Easy to insert in any context, this model can be designed for relaxation only or may have a shallow swimming area in the corners across from the beaches (minimum depth recommended for recreational swimming 100cm).

	A			B			C			D		
type	1	2	3	4	5	6	7	8	9	10	11	12
length	-	-	9,04	10,36	11,50	12,54	13,47	14,37	15,20	16,00	16,77	17,46
width	-	-	4,82	5,48	6,05	6,57	7,05	7,48	7,90	8,30	8,68	9,03
max water depth	-	-	1,3	1,4	1,5	1,6	1,6	1,6	1,6	1,6	1,6	1,6
	X	X	✓	✓	✓	✓	✓	✓	✓	✓	✓	✓

The dimensions are expressed in meters. Length and width are inclusive of the 30cm outer edge.





TP 15

The shape of this model is punctuated with various seats and curves that can be slightly modified also in the design phase to avoid existing plants. In any case, this model offers very wide relaxation areas separated from each other.

	A			B			C			D		
type	1	2	3	4	5	6	7	8	9	10	11	12
length	-	7,17	8,65	9,84	10,91	11,90	12,79	13,63	14,41	15,17	15,87	16,55
width	-	4,77	5,70	6,46	7,14	7,77	8,34	8,87	9,37	9,85	10,30	10,72
max water depth	-	1,2	1,3	1,4	1,5	1,6	1,6	1,6	1,6	1,6	1,6	1,6
	X	✓	✓	✓	✓	✓	✓	✓	✓	✓	✓	✓

The dimensions are expressed in meters. Length and width are inclusive of the 30cm outer edge.

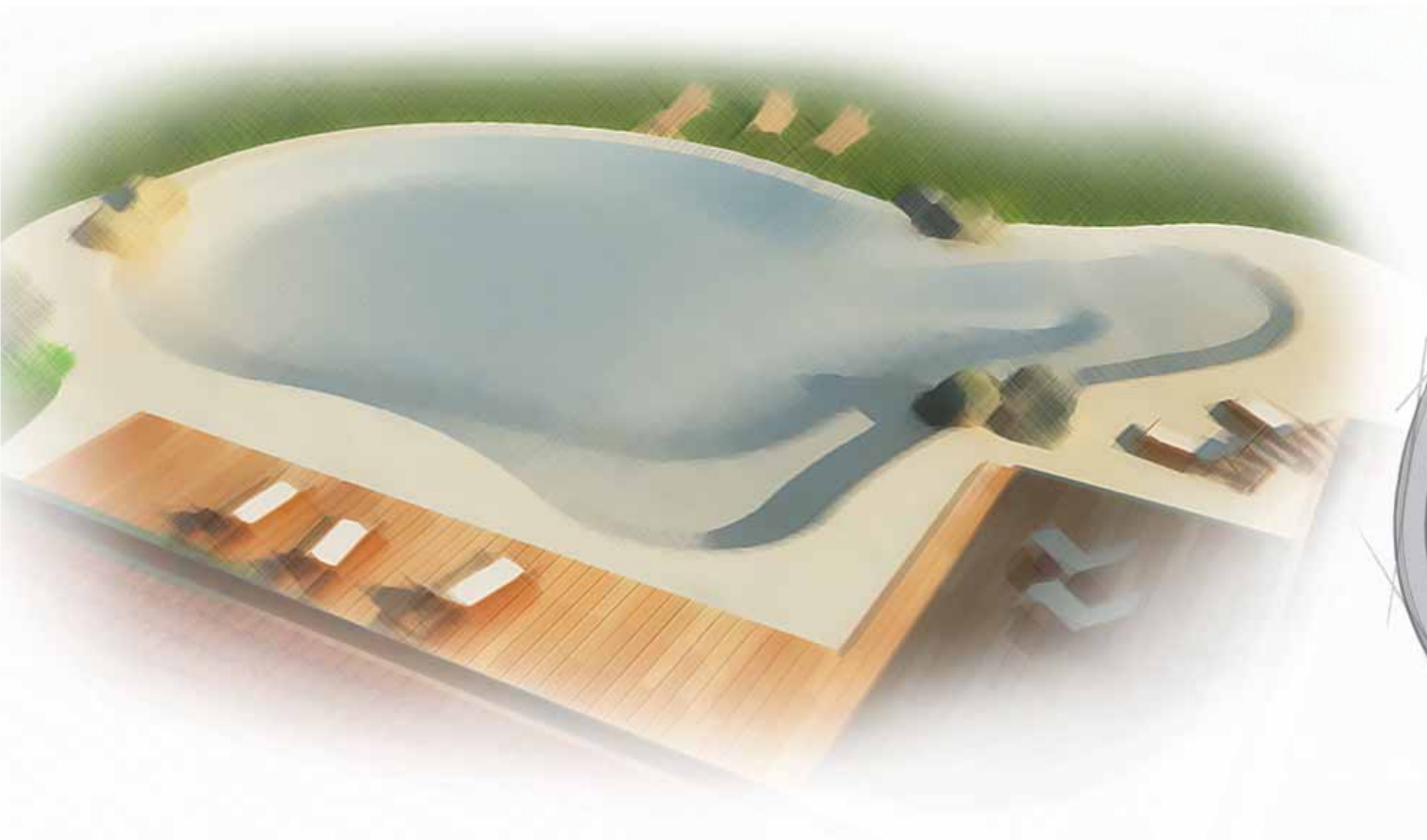
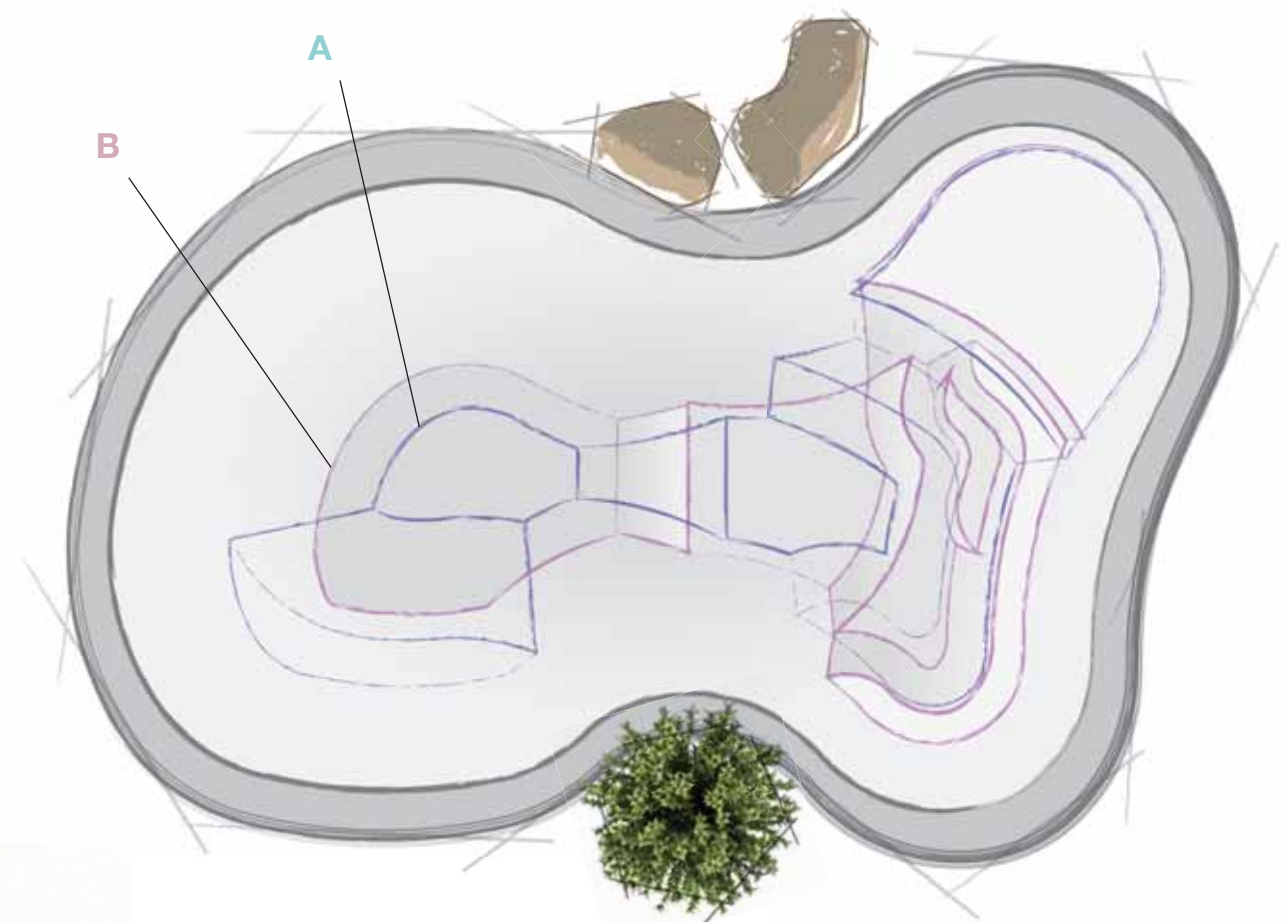

Termapond is powered by Biodesign Technology

The Biodesign technology used for the construction of Termapond pools is protected by international process patents registered in many countries around the world including Italy. Despite the simplicity and naturalness of the elements that comprise it, it is a highly technological product, therefore do not trust imitations and all the risks that come with them.

Termapond pools can only be installed by licensed contractors who have participated in special training courses and must complete the following manuals together with the principal or his legal agent:

SITE MANUAL: This manual organizes the worksite and assesses the timing required for the installation. This must be completed and signed by the principal and installer before work begins. This manual is located in the installation manual.

INSTALLATION MANUAL: This manual describes all stages of the installation in a meticulous manner. This description is then followed faithfully by the installer.

WARRANTY BOOKLET, FINAL TESTING, AND SERVICING COUPONS: This booklet must be carefully preserved by the principal for the duration of the warranty. It shall remain in the hands of the principal and contains the Termapond warranties. This manual includes the *Termapond final testing certificate*, a copy of which will be provided to the installer, and the *servicing coupon booklet* valid for the duration of the warranty. The latter is absolutely necessary and must be completed by certified Biodesign maintenance personnel any time an intervention is made on the pool. This manual enables the principal to have a traceable record of the proper maintenance carried out, as well as the quantity and quality of water treatment products added. This ensures the durability of the product and all the equipment that comprises it, in accordance with the warranties, while simultaneously offering greater control of water quality for bathers.



L'Uomo  per sua stessa natura  da sempre ricerca l'Acqua ,
e la riscopre ora in uno spazio unico, su misura:
un'armonia perfetta tra relax, paesaggio e stile.

La tecnologia costruttiva Biodesign consente di creare piscine completamente su misura,
ideali in diversi contesti e nel rispetto dell'ambiente.

Supera le limitazioni delle piscine convenzionali... Visita il nostro sito internet...

Immagina il tuo spazio e contattaci...

La tecnologia Biodesign ti permetterà di realizzarlo con semplicità.



Via Terradura, 106
35020 Maserà di Padova (PD) Italy
+39 049 8862961 +39 049 8863067
Fax +39 049 8869414

www.termapond.com
info@termapond.com